

# CKR-G-2

Depth (mm)	Width (mm)									
	600	900	1000	1200	1300	1350	1500	1650	1800	1950
400										
500										
520										
600										
650										
750			●		●			●		●
900			●		●			●		●

Handle height (from ground level)	Material	Size	Assembly	Anchor bolts
760mm	Stainless Steel	6 type	Type	included

## A sophisticated gray color that creates a refined, premium appearance.

### Features

- Made of highly corrosion-resistant hot-dip galvanized steel sheet for excellent durability
- Level adjustment can be made from inside the unit. (Adjustment range: 0–40 mm.)

#### POINT 1

### A premium gray finish.

Exterior Interior: Beige



\*The appearance of the color may vary depending on the lighting conditions.

#### POINT 2

### Quiet door operation

Door opening and closing noise is reduced by approximately 25% with the use of rotary dampers.

### Durability of rotary dampers

Passed a 100,000-cycle opening and closing test!

\* Assuming the rotary door is opened and

closed 8 times per week per household, this corresponds to approximately 20 years of use.

\* This does not guarantee the service life.

Durability may vary depending on actual usage conditions and frequency of use.



### Optional Accessories



※

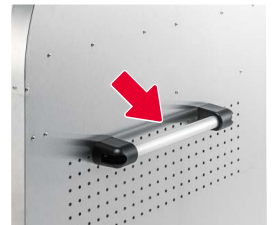

#### POINT 3

### Space-saving door

The upper door is a rotary-type door for easy operation. It rotates and stores inside the unit, enabling effective use of the upper space.

The front door uses a proprietary vertical sliding mechanism that allows opening and closing even in locations with no front clearance.



#### POINT 4

Designed with a safety clearance to help prevent fingers from being caught.



### Padlock Compatible

The latch is equipped with a temporary locking function and can be fitted with a commercially available padlock. This helps prevent unauthorized waste disposal on non-collection days and deters tampering.

\*(Padlock not included.)

- Use DAIKEN padlocks DPR-125 (Φ4 mm shackle), DPR-130 (Φ5 mm shackle), or DPR-140 (Φ6.4 mm shackle).

#### POINT 5

### Prevents waste from accumulating in corners



The dust-prevention plate helps reduce waste accumulation in corners.

#### POINT 6

### Easy to clean



※Left-side bottom panel removed

The bottom panel is removable. The bottom panel can be removed for easy cleaning of the panel and the ground underneath.



- To prevent tipping, be sure to carry out the specified anchoring work. Failure to do so may result in collapse or damage. (Anchor bolts included.)
- Do not install in locations exposed to strong winds, such as rooftops or balconies, where safety cannot be ensured.