

Slide Rack Assembly Instructions

SR-AFR/AFW/AHL/AHW

- Thank you very much for purchasing Daiken's slide-type rack.
- Please read this manual carefully to ensure proper installation.

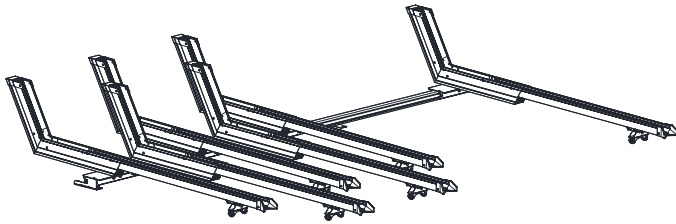

SR-AFR

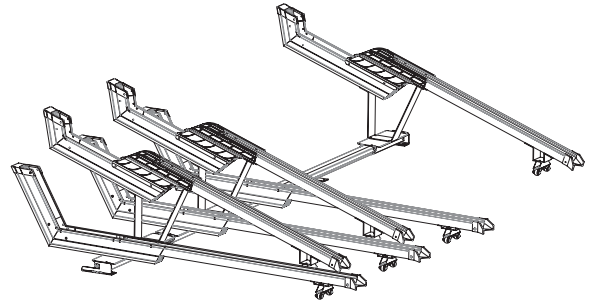

SR-AFR

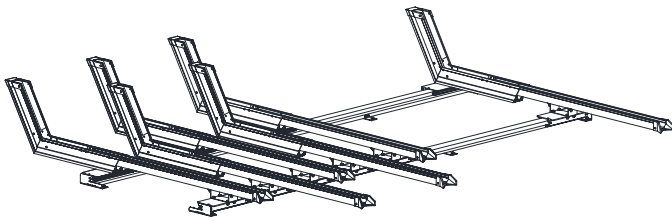

SR-AFW

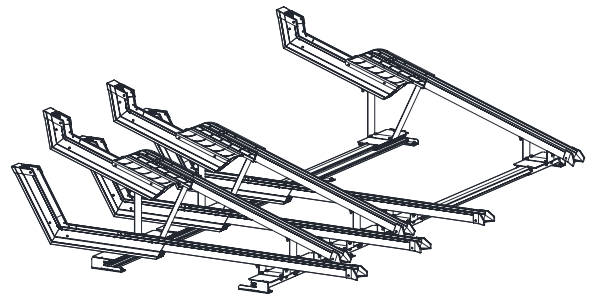

SR-AHW

1. Follow the assembly instructions during installation.
2. Install on a solid, level concrete foundation.
3. Ensure the rack is installed horizontally.
4. Do not install in unstable or high-wind locations.
5. Anchor fixing on a concrete foundation is required.
6. Install anchors only after the concrete has fully cured.
7. Remove concrete dust before anchor installation.
8. Use anchor holes of the specified size.
9. Do not modify the product.
10. Wear appropriate protective equipment during installation.
11. After installation, check all fasteners and ensure smooth rack operation.

[Packing List]

SR-AFR • AHL (Rail and Rack packed in the same carton)

Package No.	Package Name	Part Name	Qty
Y1-0104	Base Rail (4m)	Rail (4m)	1
		Rail Bracket	5
		Left End Cover	1
		Right End Cover	1
		Rail Screw Bag	1
		Warning Label	1
		Anchor Bag	1
		Assembly Manual	1
Y1-0112	Connector Rail (2m)	Rail (2m)	1
		Rail Bracket	2
		Rail Joint Bracket	1
		Rail Screw Bag	1
		Anchor Bag	1
Y1-0114	Connector Rail (4m)	Rail (4m)	1
		Rail Bracket	4
		Rail Joint Bracket	1
		Rail Screw Bag	1
		Anchor Bag	1
Y1-0203	Parts Box 3	Guide Cover	3
		Slide Fitting	3
		Caster Mounting Bracket	3
		Caster	3
		Rack Screw Bag	1
Y1-0204	Parts Box 4	Guide Cover	4
		Slide fitting	4
		Caster Mounting Bracket	4
		Caster	4
		Rack Screw Pack	1
Y1-0303	Rack 3	Rack	3
Y1-0304	Rack 4	Rack	4

Package No.	Package Name	Part Name	Qty
Y1-5202	Parts Box (Low•High)	Guide Cover	2
		Slide Fitting	2
		Caster Mounting Bracket	1
		Caster Mounting Bracket(H)	1
		Caster	2
		Support Post	1
		Rack Screw Bag	1
Y1-5203	Parts Box 3 (High)	Guide Cover	3
		Slide Fitting	3
		Caster Mounting Bracket(H)	3
		Caster	3
		Support Post	3
		Rack Screw Bag	1
Y1-5204	Parts Box 4 (High)	Guide Cover	4
		Slide Fitting	4
		Caster Mounting Bracket(H)	4
		Caster	4
		Support Post	4
Y1-5302	Rack (Low•High)	Rack	1
		Rack (High)	1
Y1-5303	Rack 3 (High)	Rack (High)	3
Y1-5304	Rack 4 (High)	Rack (High)	4

Package No.	Package Name	Part Name	Qty
Y1-0104	Base Rail (4m)	Rail (4m)	1
		Rail Bracket	5
		Left End Cover	1
		Right End Cover	1
		Rail Screw Bag	1
		Warning Label	1
		Anchor Bag	1
		Assembly Manual	1
Y1-0112	Connector Rail (2m)	Rail (2m)	1
		Rail Bracket	2
		Left End Cover	1
		Right End Cover	1
		Rail Screw Bag	1
		Anchor Bag	1
Y1-0114	Connector Rail (4m)	Rail (4m)	1
		Rail Bracket	4
		Right End Cover	1
		Left End Cover	1
		Rail Screw Bag	1
		Anchor Bag	1
Y1-2203	Parts Box 3	Guide Cover	3
		Slide Fitting	6
		Bracket AHW	3
		Rack Screw Bag	1
Y1-2204	Parts Box 4	Guide Cover	4
		Slide Fitting	8
		Bracket AHW	4
		Rack Screw Bag	1
Y1-0303	Rack 3	Rack	3
Y1-0304	Rack 4	Rack	4

Package No.	Package Name	Part Name	Qty
Y1-7202	Parts Box (Low•High)	Guide Cover	2
		Slide Fitting	4
		Support Post	1
		Bracket AHW	1
		Bracket AHW	1
		Rack Screw Bag	1
Y1-7203	Parts Box 3 (High)	Guide Cover	3
		Slide Fitting	6
		Support Post	3
		Bracket AHW	3
Y1-7204	Parts Box 4 (High)	Guide Cover	4
		Slide Fitting	8
		Support Post	4
		Bracket AHW	4
		Rack Screw Bag	1
Y1-5302	Rack (Low•High)	Rack	1
		Rack(High)	1
Y1-5303	Rack 3 (High)	Rack(High)	3
Y1-5304	Rack 4 (High)	Rack(High)	4

SR-AFR

Package No.	Rail			Part Box		Rack	
	Y1-0104	Y1-0112	Y1-0114	Y1-0203	Y1-0204	Y1-0303	Y1-0304
	Base Rail (4m)	Base Rail (4m)	Connector Rail (4m)	Part Box 3	Part Box 4	Rack 3	Rack 4
6	1	—	—	2	—	2	—
7	1	—	—	1	1	1	1
8	1	—	—	—	2	—	2
9	1	—	—	3	—	3	—
10	1	—	—	2	1	2	1
11	1	1	—	1	2	1	2
12	1	1	—	—	3	—	3
13	1	1	—	3	1	3	1
14	1	1	—	2	2	2	2
15	1	1	—	1	3	1	3
16	1	1	—	—	4	—	4
17	1	—	1	3	2	3	2
18	1	—	1	2	3	2	3
19	1	—	1	1	4	1	4
20	1	—	1	—	5	—	5

SR-AHL

Package No.	Rail			Part Box					Rack				
	Y1-0104	Y1-0112	Y1-0114	Y1-0203	Y1-0204	Y1-5202	Y1-5203	Y1-5204	Y1-0303	Y1-0304	Y1-5302	Y1-5303	Y1-5304
	Base Rail (4m)	Base Rail (4m)	Connector Rail (4m)	Part Box 3	Part Box 4	Part Box (L·H)	Part Box 3 (H)	Part Box 4 (H)	Rack 3	Rack 4	Rack (L·H)	Rack 3 (H)	Rack 4 (H)
6	1	—	—	1	—	—	1	—	1	—	—	1	—
7	1	—	—	—	1	—	1	—	—	1	—	1	—
8	1	—	—	—	1	—	—	1	—	1	—	—	1
9	1	—	—	—	1	1	1	—	—	1	1	1	—
10	1	—	—	—	1	1	—	1	—	1	1	—	1
11	1	1	—	—	1	2	1	—	—	1	2	1	—
12	1	1	—	2	—	—	2	—	2	—	—	2	—
13	1	1	—	1	1	—	2	—	1	1	—	2	—
14	1	1	—	1	1	—	1	1	1	1	—	1	1
15	1	1	—	—	2	—	1	1	—	2	—	1	1
16	1	1	—	—	2	—	—	2	—	2	—	—	2
17	1	—	1	—	2	1	1	1	—	2	1	1	1
18	1	—	1	—	2	1	—	2	—	2	1	—	2
19	1	—	1	—	2	2	1	1	—	2	2	1	1
20	1	—	1	—	2	2	—	2	—	2	2	—	2

SR-AFW

Package No.	Rail			Part Box		Rack	
	Y1-0104	Y1-0112	Y1-0114	Y1-2203	Y1-2204	Y1-0303	Y1-0304
	Base Rail (4m)	Base Rail (4m)	Connector Rail (4m)	Part Box 3	Part Box 4	Rack 3	Rack 4
6	2	—	—	2	—	2	—
7	2	—	—	1	1	1	1
8	2	—	—	—	2	—	2
9	2	—	—	3	—	3	—
10	2	—	—	2	1	2	1
11	2	2	—	1	2	1	2
12	2	2	—	—	3	—	3
13	2	2	—	3	1	3	1
14	2	2	—	2	2	2	2
15	2	2	—	1	3	1	3
16	2	2	—	—	4	—	4
17	2	—	2	3	2	3	2
18	2	—	2	2	3	2	3
19	2	—	2	1	4	1	4
20	2	—	2	—	5	—	5

SR-AHW

Package No.	Rail			Part Box					Rack				
	Y 1-0104	Y 1-0112	Y 1-0114	Y 1-2203	Y 1-2204	Y 1-7202	Y 1-7203	Y 1-7204	Y 1-0303	Y 1-0304	Y 1-5302	Y 1-5303	Y 1-5304
	Base Rail (4m)	Base Rail (4m)	Connector Rail (4m)	Part Box 3	Part Box 4	Part Box (L·H)	Part Box 3 (H)	Part Box 4 (H)	Rack 3	Rack 4	Rack (L·H)	Rack 3 (H)	Rack 4 (H)
6	2	—	—	1	—	—	1	—	1	—	—	1	—
7	2	—	—	—	1	—	1	—	—	1	—	1	—
8	2	—	—	—	1	—	—	1	—	1	—	—	1
9	2	—	—	—	1	1	1	—	—	1	1	1	—
10	2	—	—	—	1	1	—	1	—	1	1	—	1
11	2	2	—	—	1	2	1	—	—	1	2	1	—
12	2	2	—	2	—	—	2	—	2	—	—	2	—
13	2	2	—	1	1	—	2	—	1	1	—	2	—
14	2	2	—	1	1	—	1	1	1	1	—	1	1
15	2	2	—	—	2	—	1	1	—	2	—	1	1
16	2	2	—	—	2	—	—	2	—	2	—	—	2
17	2	—	2	—	2	1	1	1	—	2	1	1	1
18	2	—	2	—	2	1	—	2	—	2	1	—	2
19	2	—	2	—	2	2	1	1	—	2	2	1	1
20	2	—	2	—	2	2	—	2	—	2	2	—	2

[Accessories]

Rail Package

Bag Name	Part Name	Size	Base Rail 4m	Connector Rail 2m	Connector Rail 4m
Bag Name	Spacer	t2.0	10	4	8
	Truss Head Screw	M6 × 15	10	6	10
Bag Name	Anchor Bolt (with Washer and Nut)	M8 × 70	10	4	8

Rail Package [AFR • AHL]

Bag Name	Part Name	Size	Part Box 3	Part Box 4	Part Box (L•H)	Part Box 3 (H)	Part Box 4 (H)	
Rack Screw Bag	Screw Bag A	Hex Bolt	M8 × 20	24	32	20	36	48
	Screw Bag B	Flat Washer	M8	24	32	24	48	64
		Spring Washer	M8	24	32	20	36	48
		Hex Nut	M8	24	32	20	36	48
	Screw Bag C	Truss Head Screw	M6 × 15	6	8	4	6	8
		Flat Washer	M6	6	8	4	6	8
		Spring Washer	M6	6	8	4	6	8
		Pan Head Screw	M4 × 10	6	8	4	6	8

Rail Package [AFW • AHW]

Bag Name	Part Name	Size	Part Box 3	Part Box 4	Part Box (L•H)	Part Box 3 (H)	Part Box 4 (H)	
Rack Screw Bag	Screw Bag A	Hex Bolt	M8 × 20	36	48	28	48	64
	Screw Bag B	Flat Washer	M8	48	64	40	72	96
		Spring Washer	M8	36	48	28	48	64
		Hex Nut	M8	36	48	28	48	64
	Screw Bag C	Pan Head Screw	M4 × 10	6	8	4	6	8

[Parts]

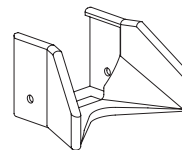
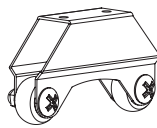
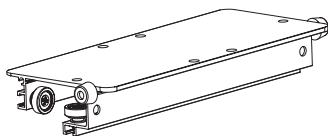
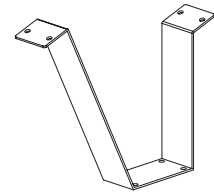
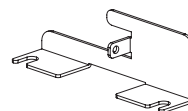
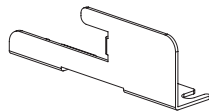
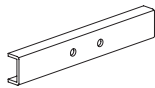
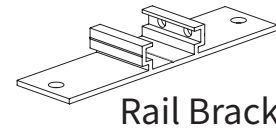

Support Post

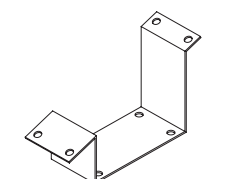
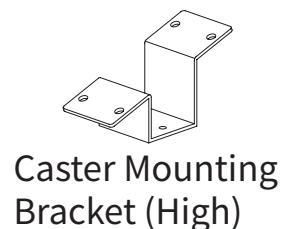
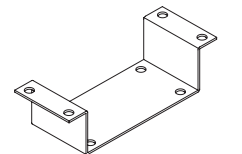
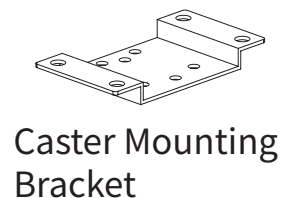

SR-AFR 6 units

⊙ Front-to-back offset
400mm

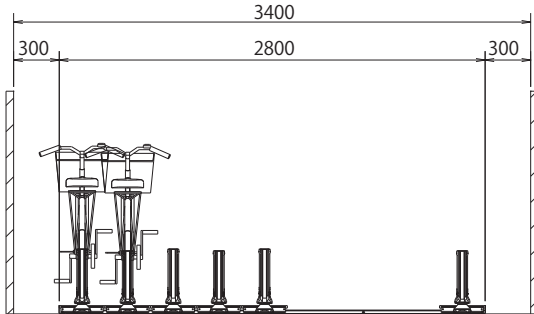
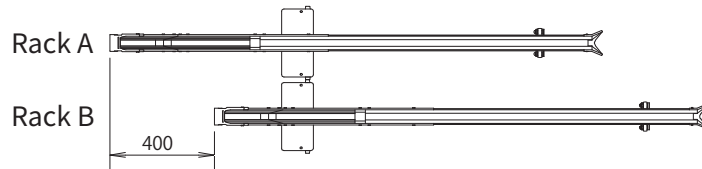

Front View

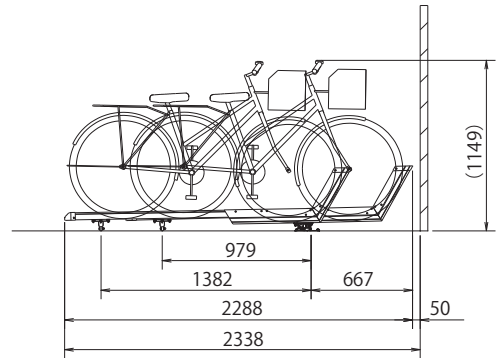

Side View



Plan View

Aisle Width
1500 mm or more

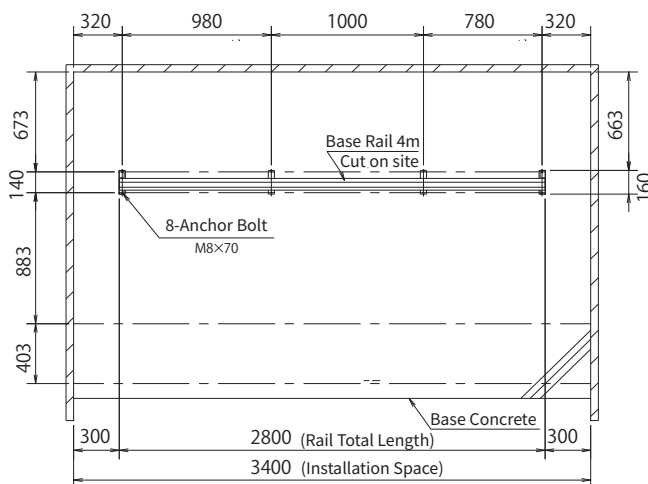
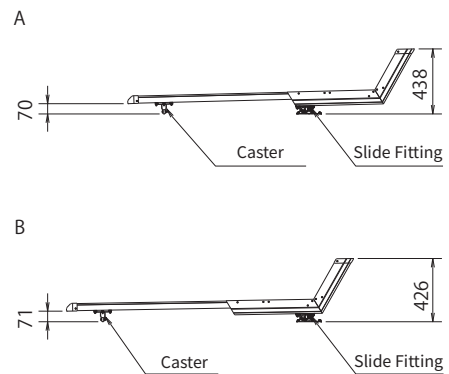

Foundation Plan

*The rail must be installed level. Adjust the level if there is any slope.
Slope criteria: 1.0% max. in the depth direction, 0.5% max. in the width direction.

*The floor surface at the caster running position must be concrete or a flat surface.

SR-AFR 6 units

⊙ Front-to-back offset
450mm

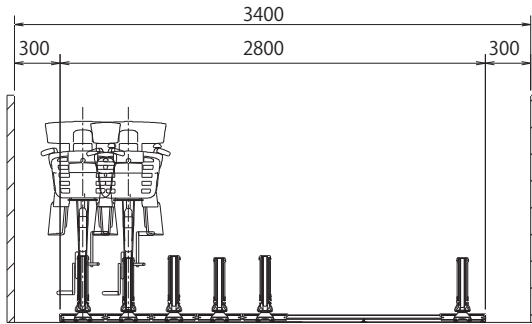
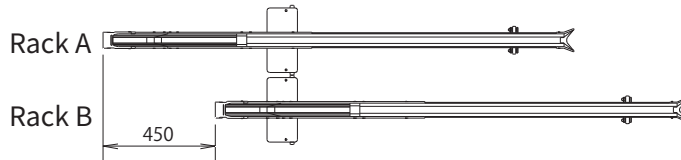

Front View

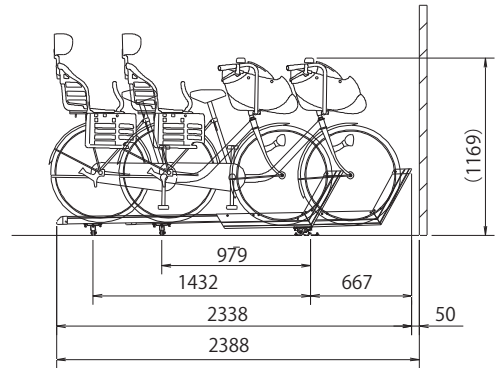

Side View

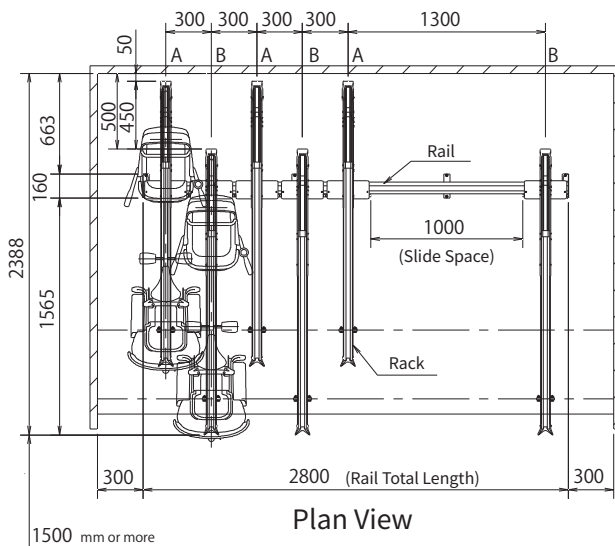

Plan View

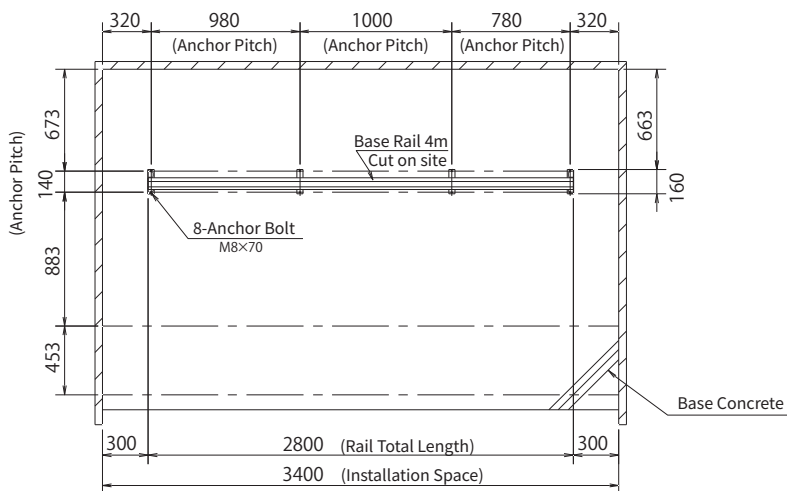
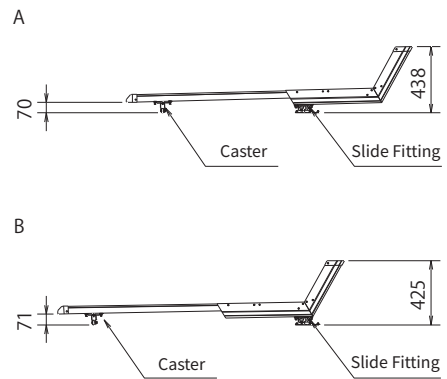

Foundation Plan

*The rail must be installed level. Adjust the level if there is any slope.
Slope criteria: 1.0% max. in the depth direction, 0.5% max. in the width direction.

*The floor surface at the caster running position must be concrete or a flat surface.

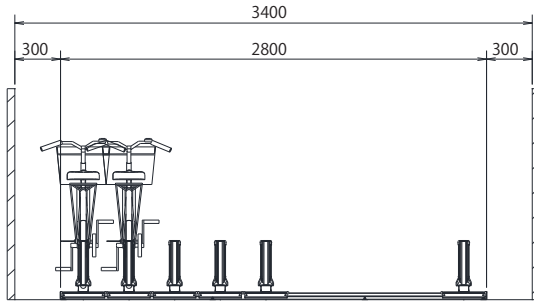
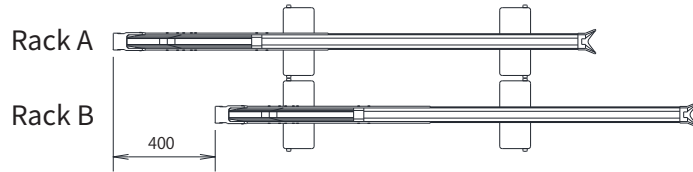

Front View

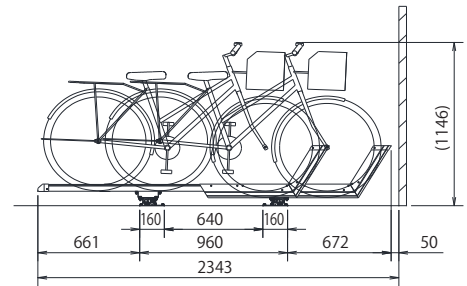

Side View

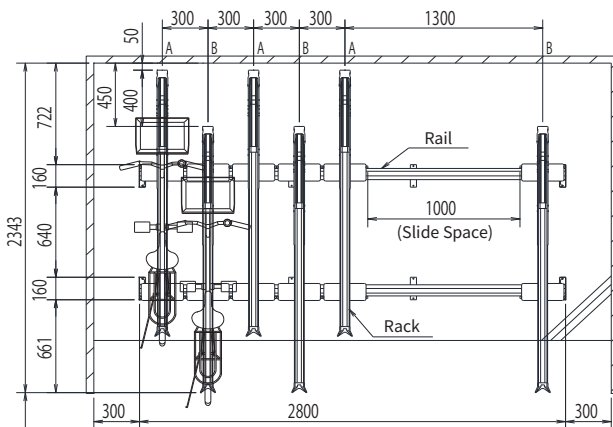

Plan View

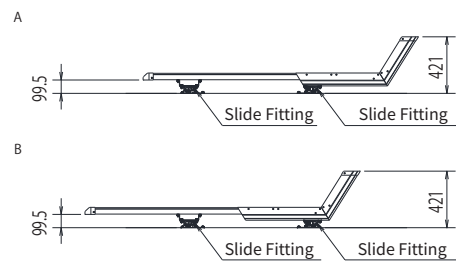

1500 mm or more

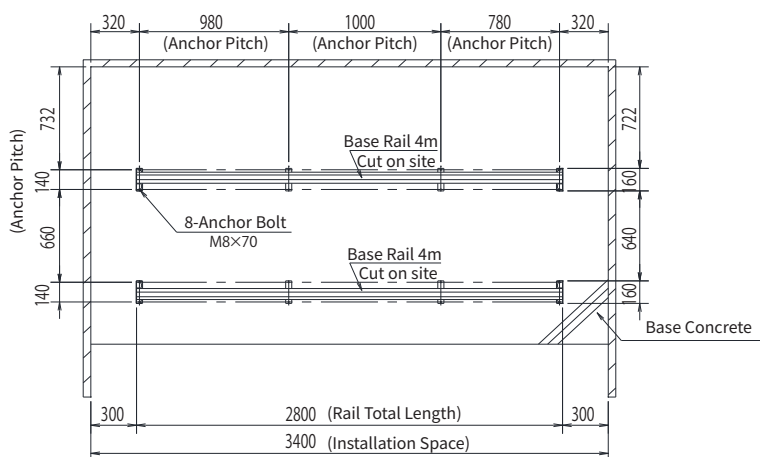

Foundation Plan

- *The rail must be installed level. Adjust the level if there is any slope.
Slope criteria: 1.0% max. in the depth direction, 0.5% max. in the width direction.
- *The floor surface at the caster running position must be concrete or a flat surface.

SR-AFW 6 units

⊙ Front-to-back offset
450mm

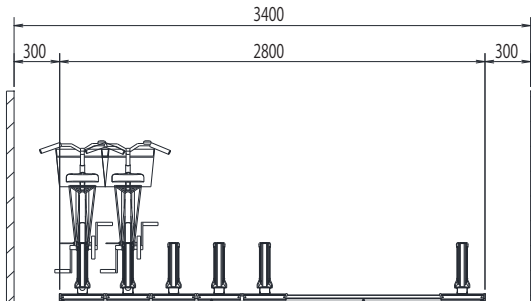
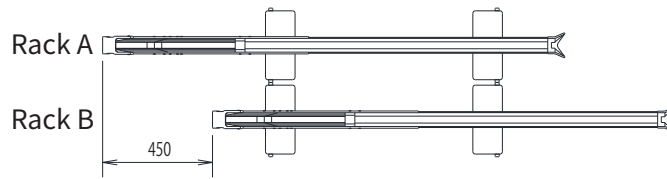

Front View

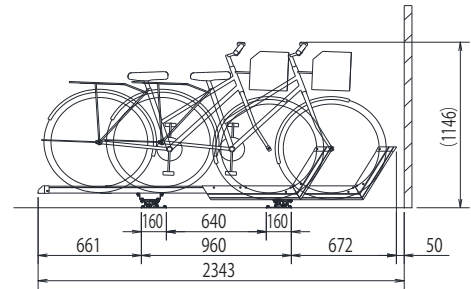

Side View

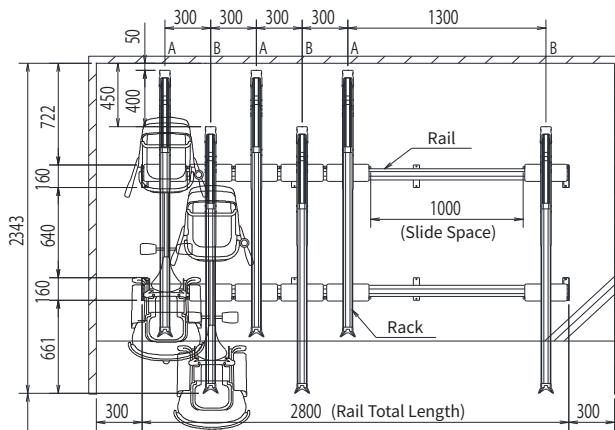

Plan View

Aisle Width
1500 mm or more

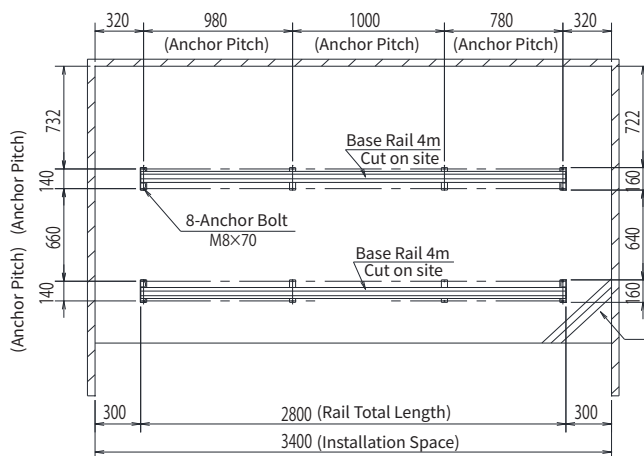
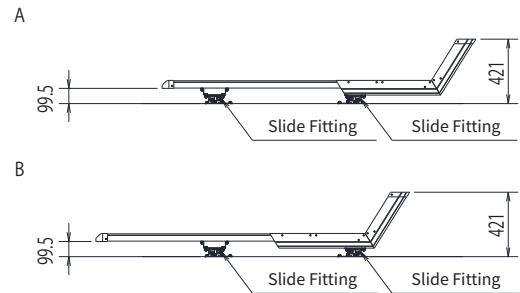

Foundation Plan

*The rail must be installed level. Adjust the level if there is any slope.
Slope criteria: 1.0% max. in the depth direction, 0.5% max. in the width direction.

*The floor surface at the caster running position must be concrete or a flat surface.

SR-AFW 6 units

○ Front-to-back offset 400mm

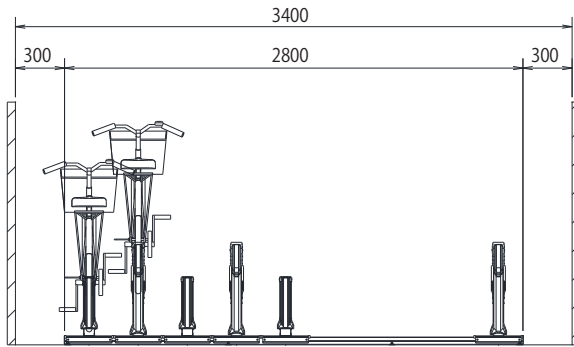

Front View

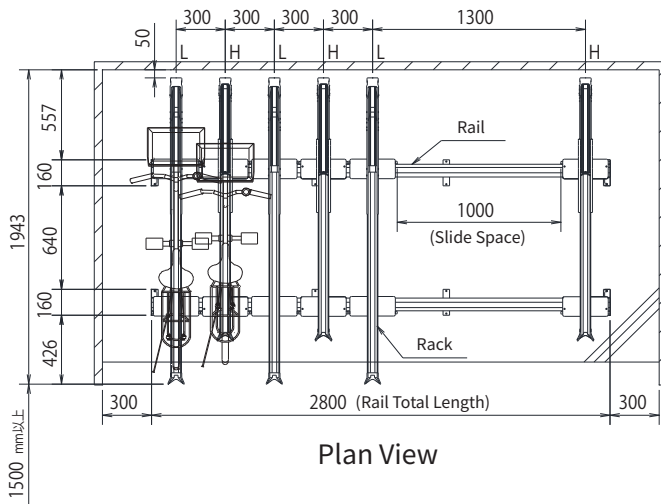
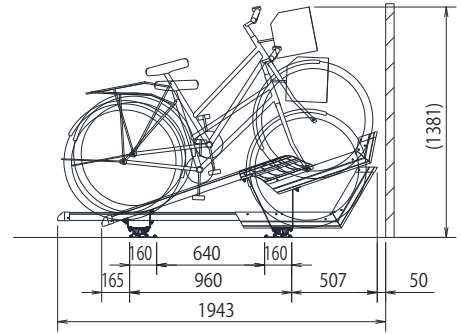

Plan View

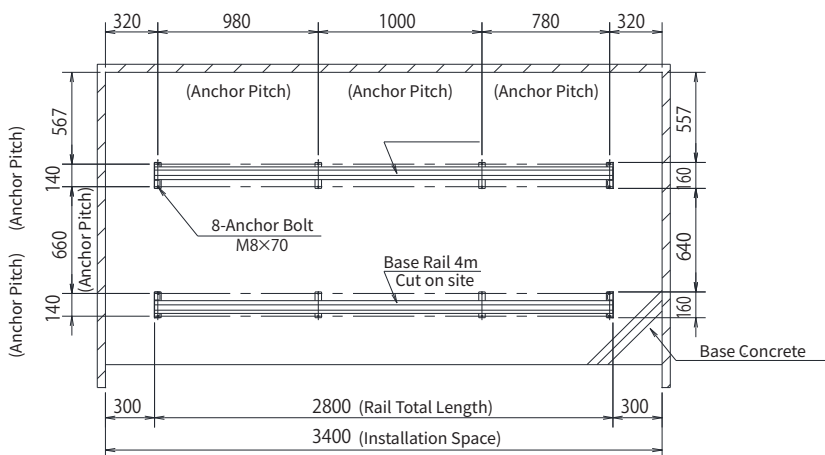
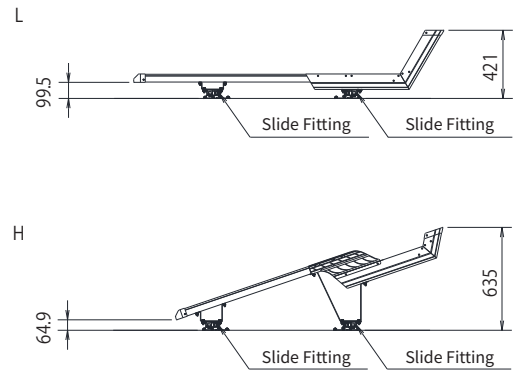

Foundation Plan

- *The rail must be installed level. Adjust the level if there is any slope.
Slope criteria: 1.0% max. in the depth direction, 0.5% max. in the width direction.
- *The floor surface at the caster running position must be concrete or a flat surface.

[Rail Layout Drawing]

Rail length must be cut and drilled on site according to the number of units

*Refer to Rail Processing Instructions

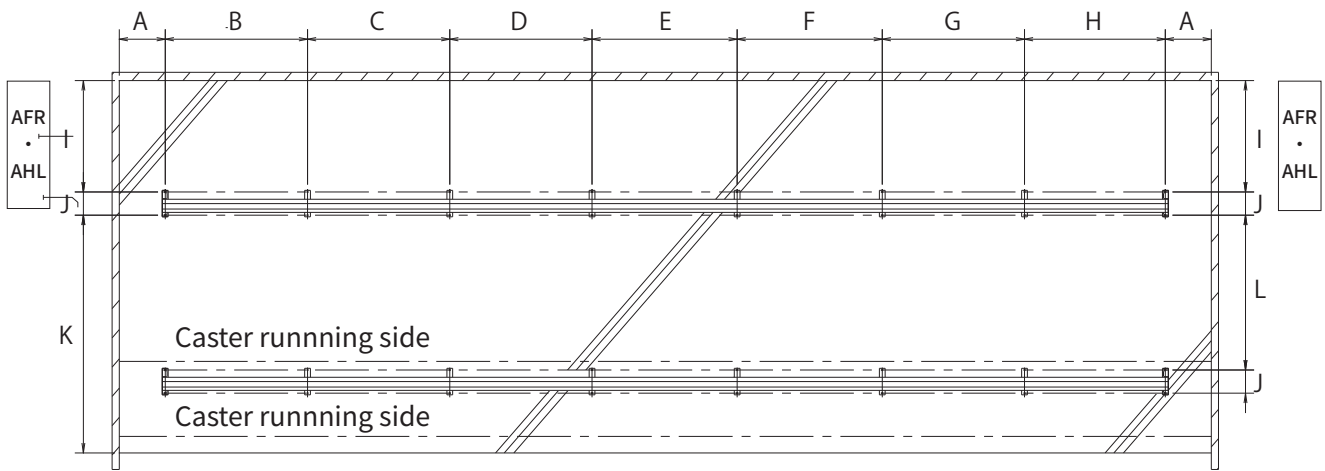

Units	Total Rail Length	Install Space	Anchor Pitch								Depth Dimension				Rail Length
			A	B	C	D	E	F	G	H	I	J	K	L	
6	2800	3400				780	-	-	-	-					
7	3100	3700					80	-	-	-					
8	3400	4000					380	-	-	-	AFR		AFR		4m
9	3700	4300					680	-	-	-	673		1386		
10	4000	4600					980	-	-	-			Front-to-back offset 400mm		
11	4300	4900						280	-	-	AHL				
12	4600	5200						580	-	-	518				
13	4900	5500	380	980	1000	1000		880	-	-		140	AFR	660	4m + 2m
14	5200	5800							180	-	AFW		1436		
15	5500	6100							480	-	732		Front-to-back offset 450mm *1 *2		
16	5800	6400							780	-					
17	6100	6700								80	AHW		AHL		4m x 2
18	6400	7000								380	567		1139		
19	6700	7300								680					
20	7000	7600								980					

○ Total Rail Length Calculation (Up to 20 units)

Total Rail Length = Rack Pitch x Units Qty + Slide Space
 ex. 300mm x 10units + 1

○ Installation Space Calculation

Installation Space = Total Rail Length + End Clearance
 ex. 300mm x 10units + 1

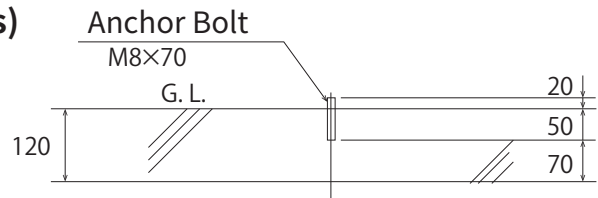

*Anchor Drill Diameter: 8.5mm
 Hole Depth : 58mm
 (Drill slightly deeper as needed.)

○ Installation Space Calculation (21 units or more) *Provide 50mm gap every 20 units

Installation Space = Total Rail Length + Separation Space + End Clearance
 ex. 21 Units (10 + 11 Units)
 (4000mm + 4300mm) + (50mm x 1 spot) + 300mm x 2 spots = 8300mm

*For heavy bicycles (ex. child-seat bikes), fewer units are recommended.

[Rail Processing]

○Rail Cutting

Cut the rail to the required length according to the units. (See Rail Layout)

Package	Name	Rail Length
Y1-010 4	Base Rail 4m	4000 mm
Y1-011 2	Connector Rail 2m	2000 mm
Y1-011 4	Connector Rail 4m	4000 mm

(Ex.) 16 Units Total Rail Length: 5800 mm

Rail Quantity $\left\{ \begin{array}{l} \text{Rail 4000mm} \quad \overset{\text{AFR} \cdot \text{AHL}}{1 \text{ Rail}} \leftarrow \bigcirc \times 2 \\ \text{Rail 2000mm} \quad \overset{\text{AFW} \cdot \text{AHW}}{1 \text{ Rail}} \leftarrow \bigcirc \times 2 \end{array} \right.$

Cut Length: 4000 mm + 2000 mm – 5800 mm = 200 mm

(*Cut 200 mm from the 2000 mm rail.)

○End Hole Drilling

Drill holes as shown for mounting rail brackets, end caps, and connectors.

Drill **Ø6.5 mm x 1 hole** and **Ø7.5 mm x 1 hole**, referring to rail grooves.

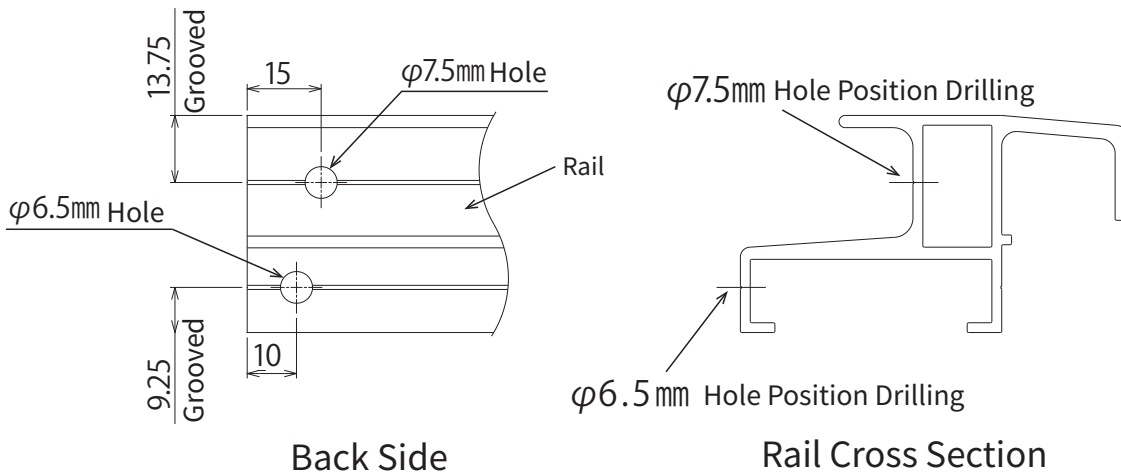

○When adjusting intermediate anchor pitch

Keep anchor pitch within **1010 mm**.

Order additionally rail brackets as needed and reposition.

Drill **Ø6.5 mm x 2 holes** at rail grooves.

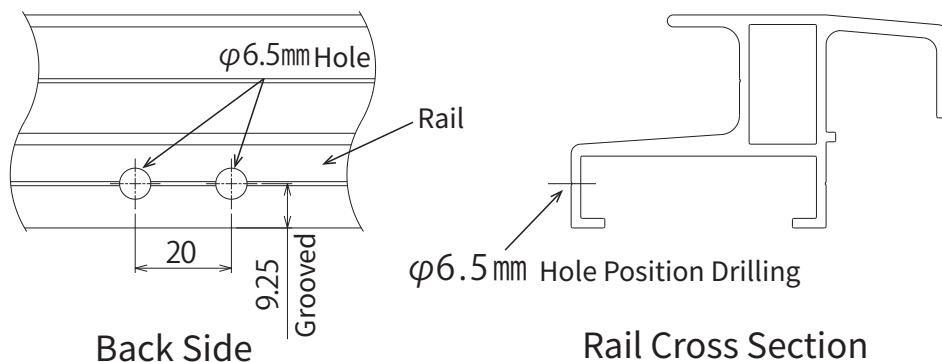

① Rack Assembly

○ Attach connecting parts and end components

- Slide rail brackets in from the side of the rail (place drilled hole side at the rear).
- Install connecting parts with no gaps.

*Note: Install rails horizontally. If inclined, adjust level.
Allowable slope: $\leq 1.0\%$ (longitudinal), $\leq 0.5\%$ (transverse).

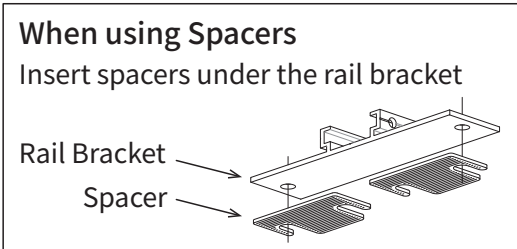
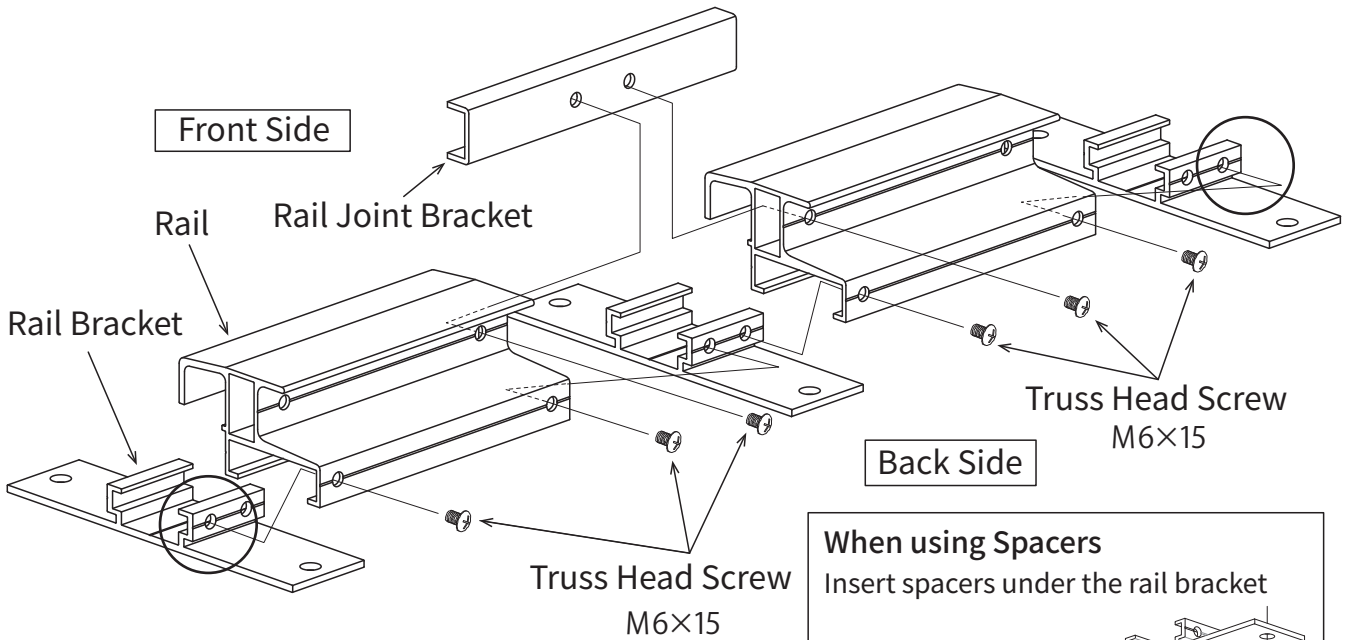

• Rail Installation direction

AFR_{Type}
AHL_{Type}



AFW_{Type}
AHW_{Type}



○ Installing the middle section

- Slide the rail brackets from the end and secure at two points with screws.

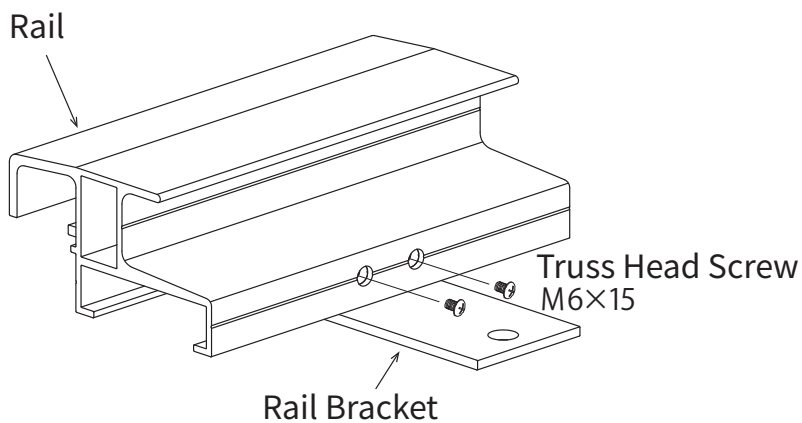

② Rack Assembly

○ Attach Slide Bracket (AFR•AHL Low Rack)

• Insert screws into the front wheel guide and fix the slide fitting at the position below.

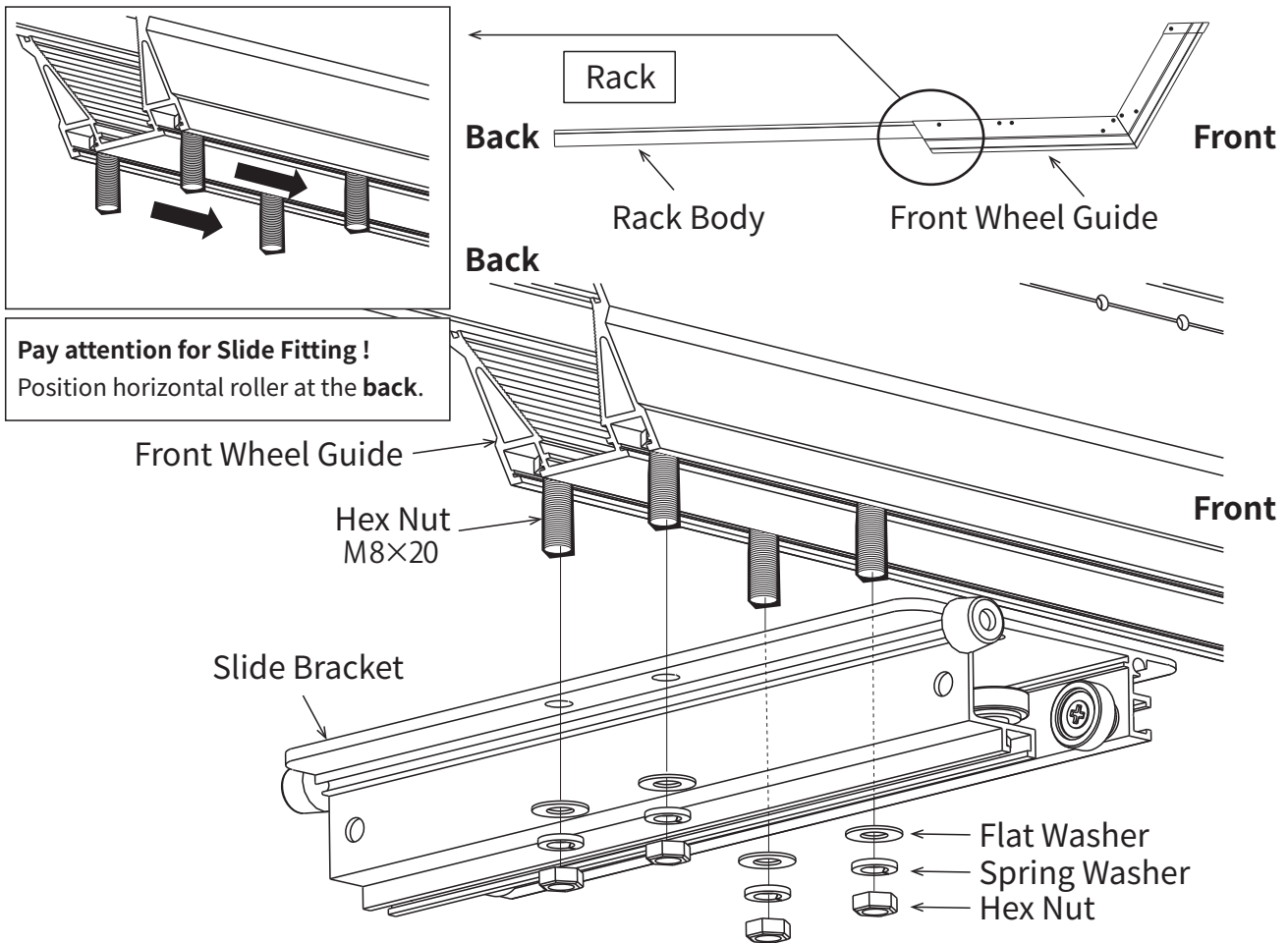

Pay attention for Slide Fitting !
Position horizontal roller at the **back**.

Mounting Position

*Cut out the sticker printed on the top of the parts box and use it as a guide for installing the slide brackets.

SR-AFR Rack [A fixed position] SR-AHL Rack [fixed position] SR-AFR Rack [B fixed position]

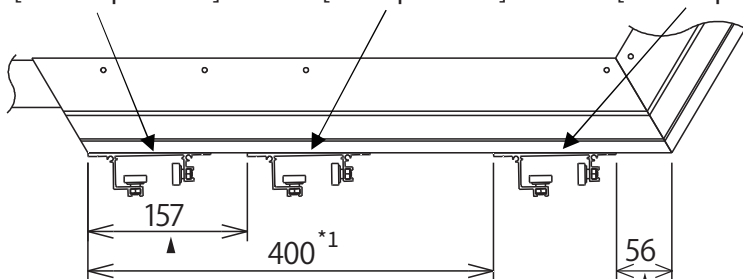

Sticker

← Caster 137.5mm →				Slide Fittings (P400) RackB ← 56mm →
DAIKEN Slide Rack				
Y1-0203				
SR-AFR	Box 3	Lot No.		
← Using SR-AHL Slide Fittings Low Rack 157mm →				

○ If bicycle storage is tight

Adjust the slide fittings to change the staggered depth up to 450mm.

*1

A depth difference under 400mm may cause bicycles to touch and reduce handling space.
A 450mm difference is recommended for 3-seater family bicycles.

② Rack Assembly

○ Bracket & Support Post Installation (AHL High Rack)

• Fix the support post to the slide fittings.

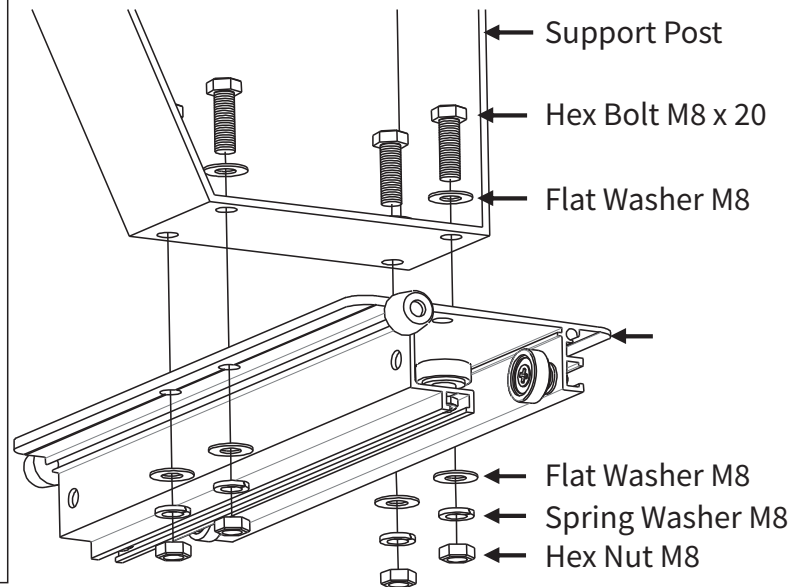
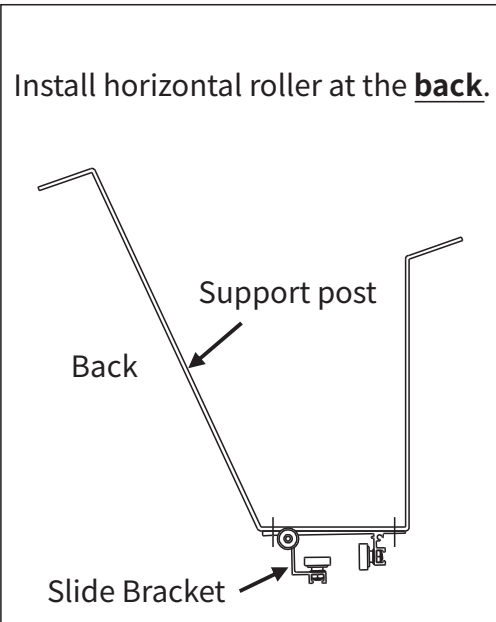

○ Rack & Post Installation

• Insert bolts and secure at the specified positions.

*Use the box-top template as an installation guide.

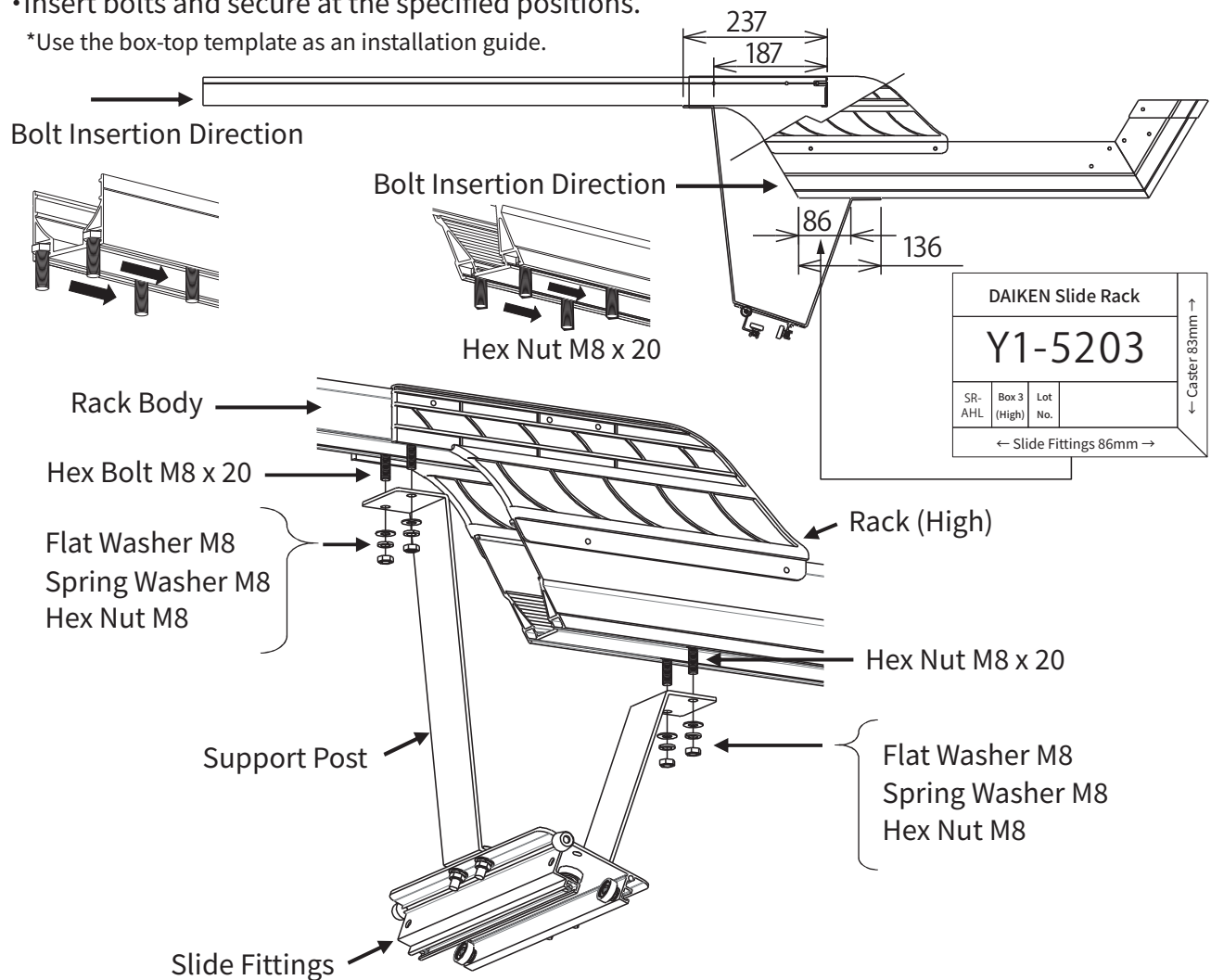

② Rack Assembly

○ Mounting Caster (AFR•AHL Low Rack)

- Fix the support post to the slide fittings.
- Install the caster brackets at the specified positions (see below).

* Use the box-top template as an installation guide.

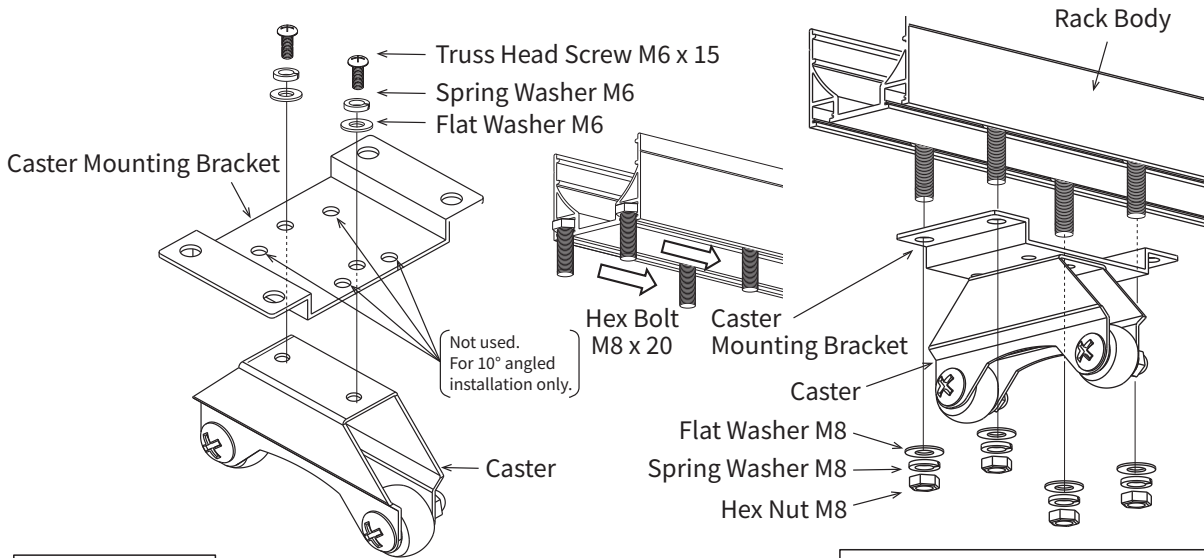

Mounting Position

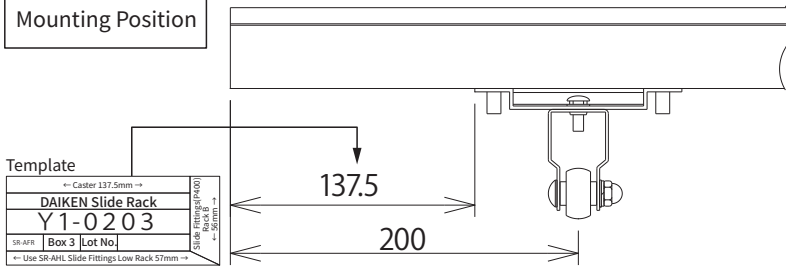

When using Spacer

Install the spacer between the caster bracket and rack frame as shown.

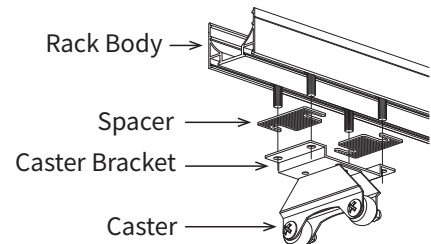

○ Mounting Caster (AHL High Rack)

- Fix the support post to the slide fittings.
- Install the caster brackets at the specified positions (see below).

* Use the box-top template as an installation guide.

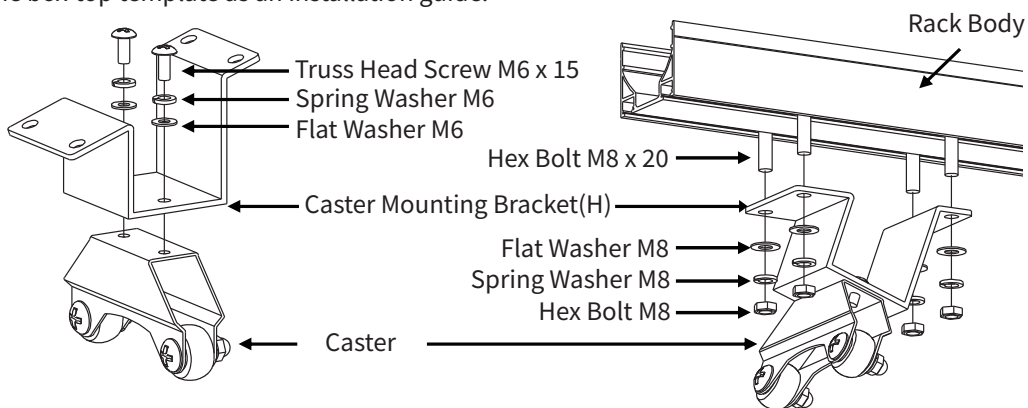

Mounting Position

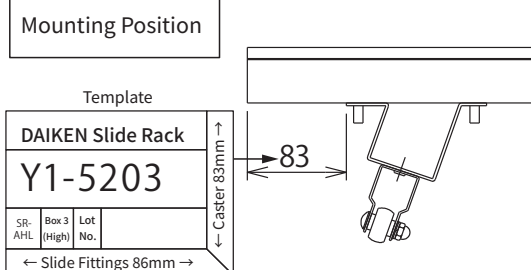

When using Spacer

Install the spacer between the caster bracket and rack frame as shown.

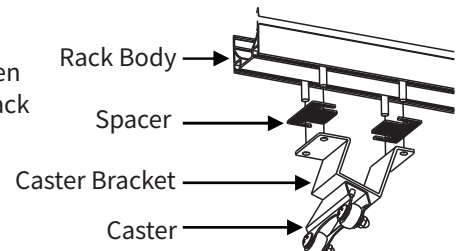

② Rack Assembly

○ Mounting Caster (AFW•AHW Low Rack)

- Same installation method as AFR/AHL models.
- Secure the slide fittings at the positions shown below.

***Slide fitting direction differs from AFR/AHL models.**

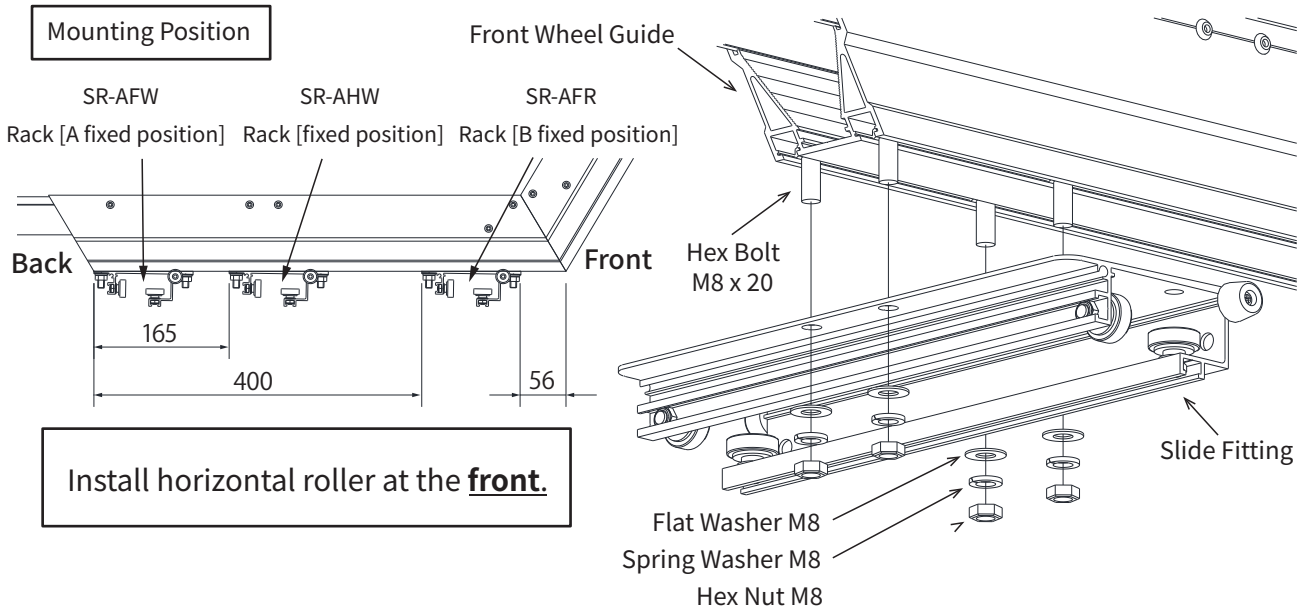

○ If bicycle storage is tight

Adjust the slide fittings to change the staggered depth up to 450mm.

- *1 A depth difference under 400mm may cause bicycles to touch and reduce handling space. A 450mm difference is recommended for 3-seater family bicycles.

- Insert screws into the rack frame and secure the slide fittings and AFW brackets (see below).

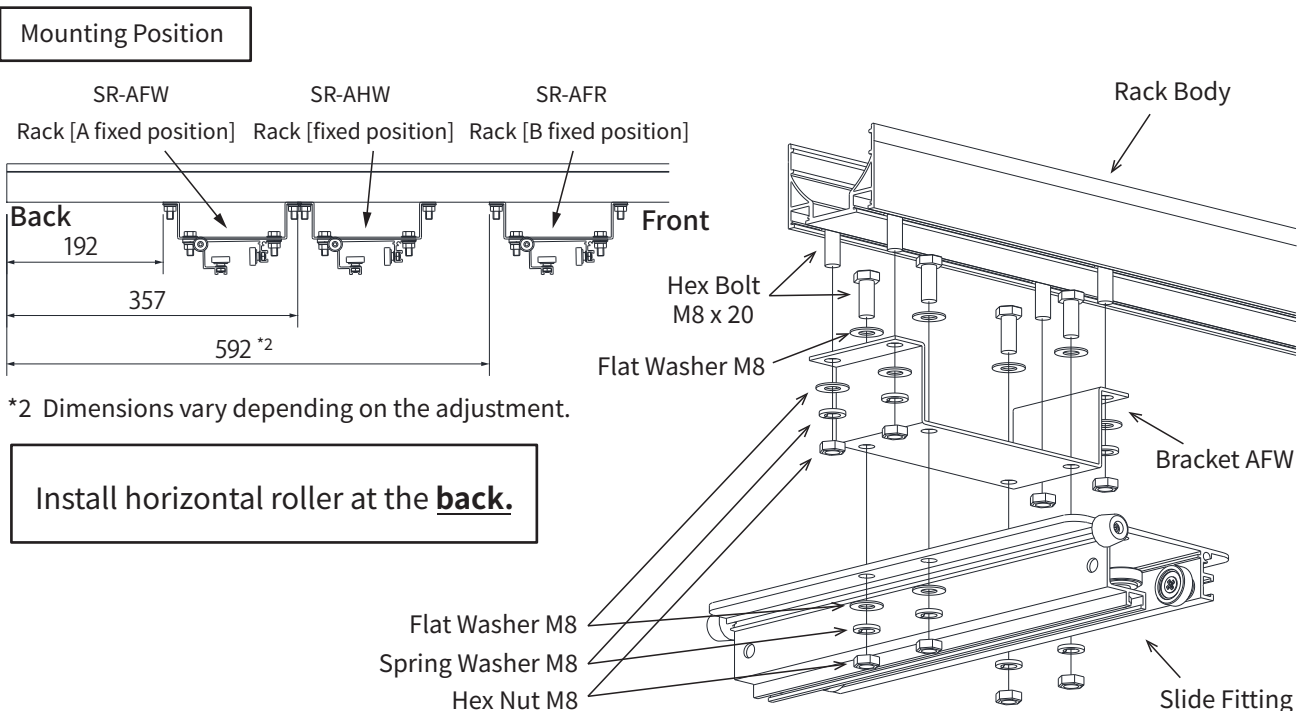

② Rack Assembly

- Secure the support post and slide fittings at the positions shown below.

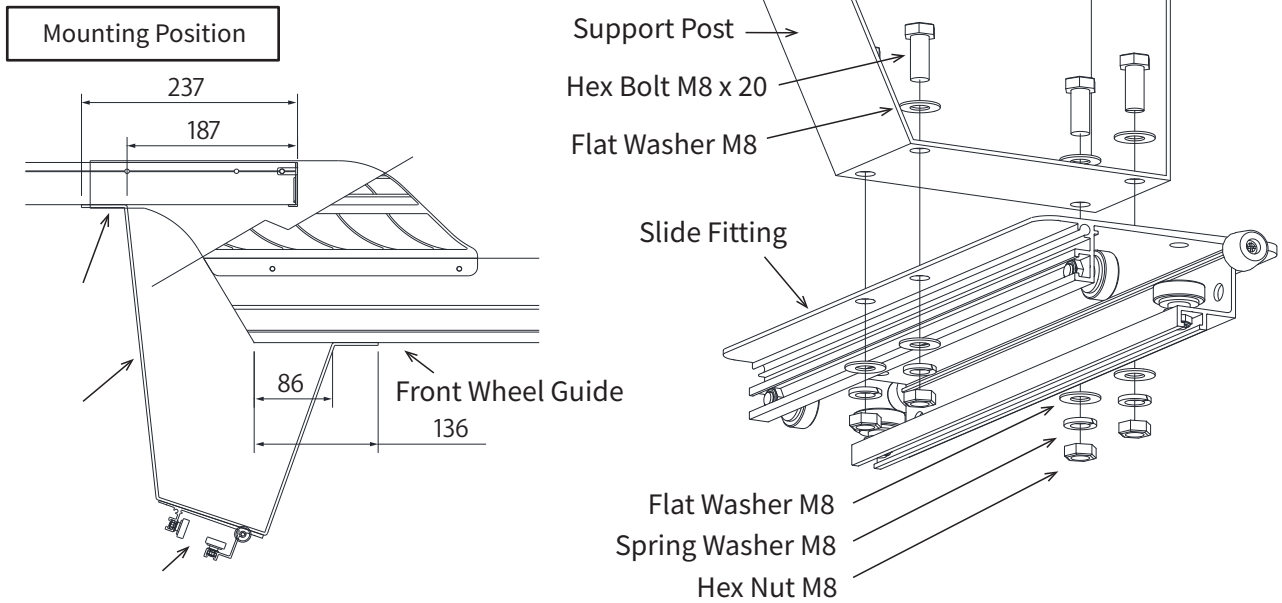

Install horizontal roller at the **front**.

- Insert screws into the rack frame and secure the slide fittings and AHW brackets (see below).

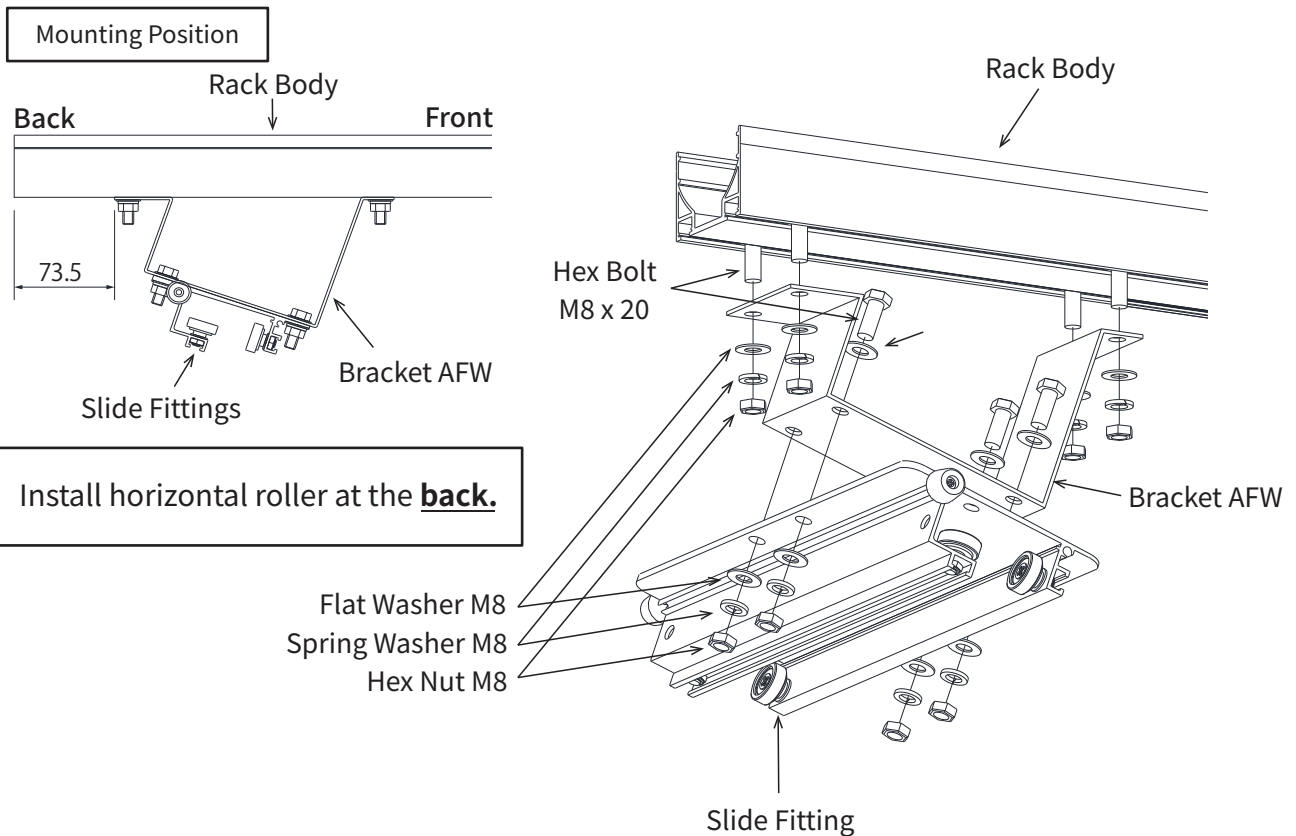

Install horizontal roller at the **back**.

② Rack Assembly

○ Mounting Caster (AFW•AHW Low Rack)

- Insert the guide cover and secure it through the holes in the plastic part.
(No holes are provided in the rack frame.)

***If using a stopper, install it first.
(Refer to the stopper assembly instructions.)**

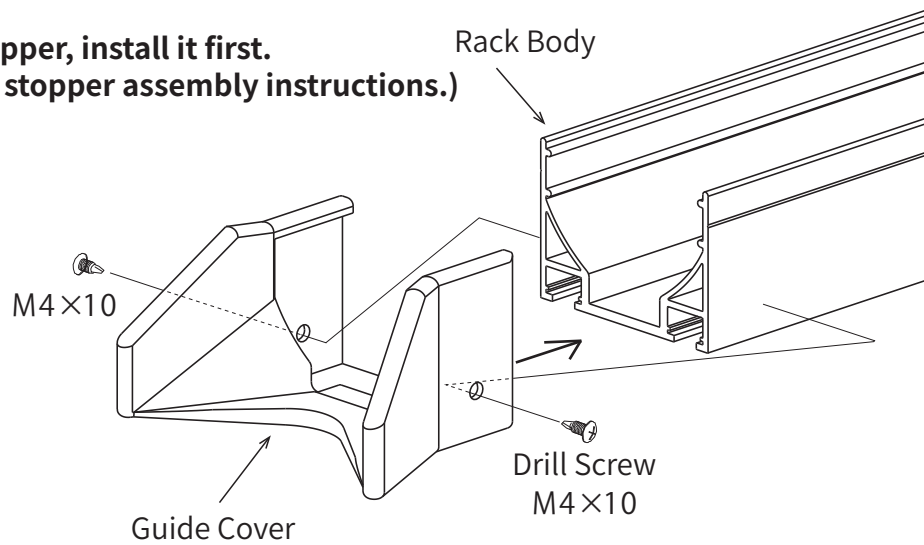

③ End Cover Assembly

○ End Cover Installation

Insert the rack into the rail and install the end covers.

- *1 Slide the end covers onto the rail brackets and secure with truss head screws and anchor bolts.

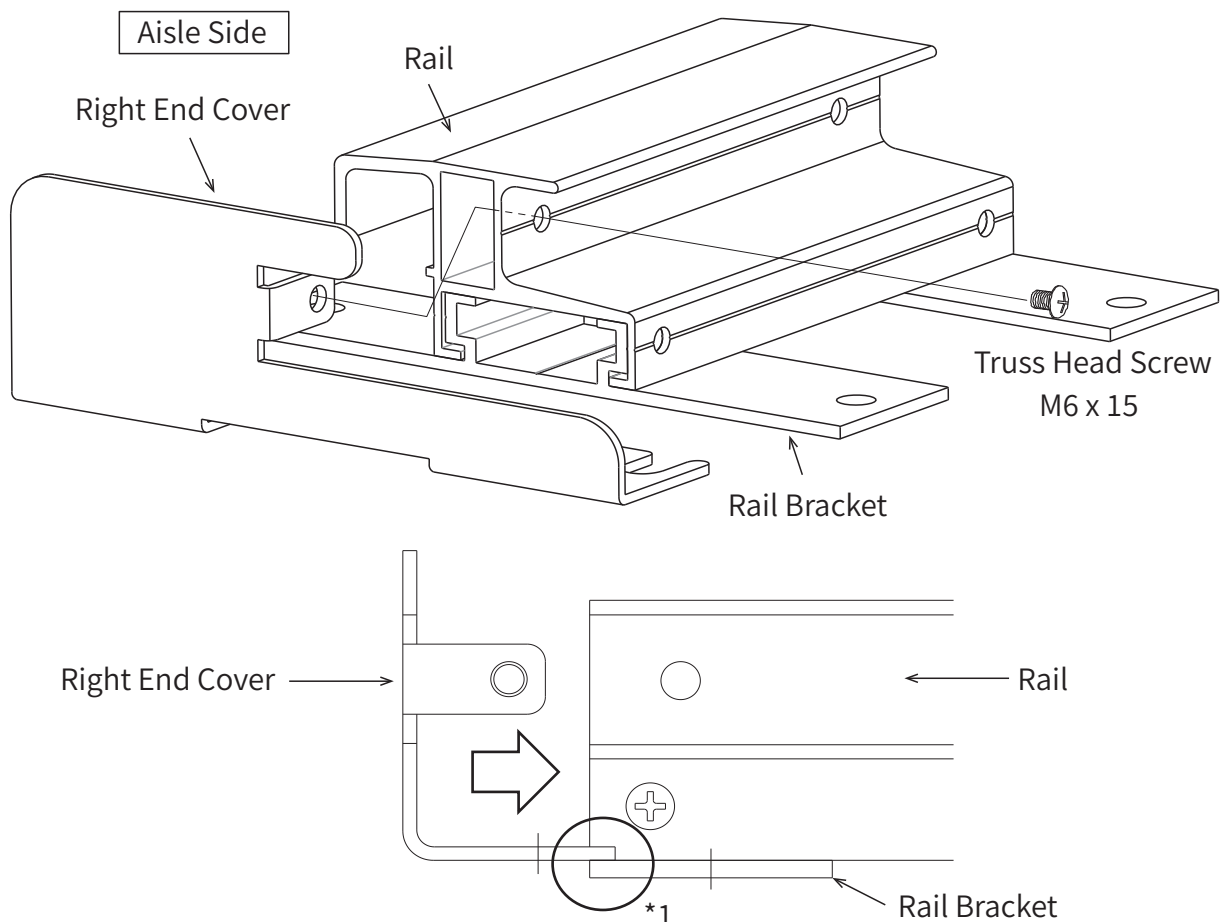

④ Warning Label Application

○ Warning Label

- Apply the label to a visible area on the rail.

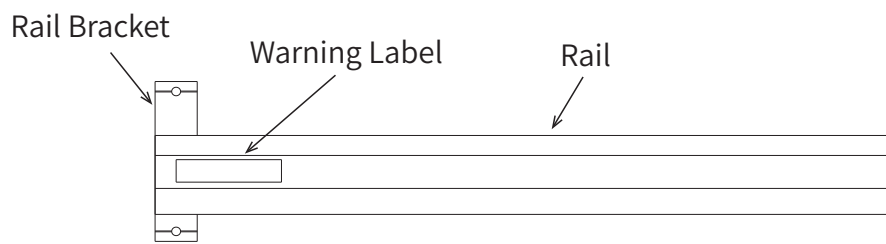

Make Sure to check all screws and operation.