

Aluminum Canopy

(RS Visor R S – M S 60, 55, 50, 45, 40, 35 model)

Installation Manual

Thank you for choosing Daiken products.

To ensure correct installation and product safety, please be sure to read this **Installation Manual** carefully before installation.

— Contents —

Important Notes for Installation	1
Anchor Installation Instructions	2
Installation Steps	2~3
When two or more canopy panels are connected	4
When there is a corner	4



Installation Notes



- ☐ Do not stand on or hang from the canopy to avoid the risk of falling or damage.
- ☐ Be sure to tighten all screws and bolts securely.
- ☐ After installation, check the screws and bolts for looseness
and ensure there are no hazardous conditions.
- ☐ Do not use non-standard installation methods or modify the product.

※Please note that some parts of the product may be changed without prior notice for improvement.

Anchor Installation

Make sure the anchor bolts protrude 20 mm from the mounting surface, as shown in the right figure.

- ※ Seal around the anchor bolts with waterproof material to prevent water intrusion.
- ※ Install the anchors according to the specified embedment depth.
- ※ Use post-installed anchors only for RC structures.

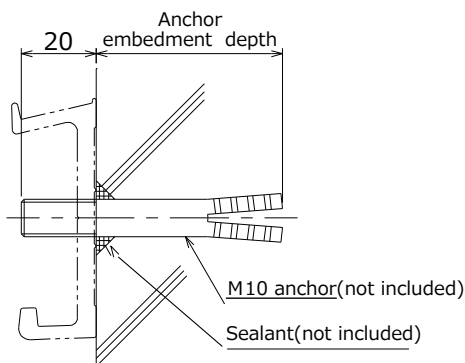

Caution

Ensure that the anchor embedment depth is measured from the structural body and does not include the thickness of finishing materials such as mortar or tiles.

Anchor Position

Position the anchors within **80 mm from each end of the canopy width (W), and at intervals of max. 400 mm.**

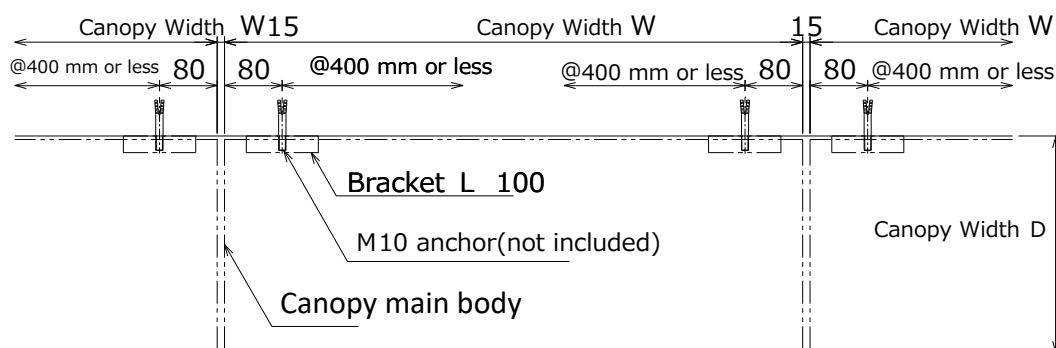

Caution

If the bracket is a continuous type, one bracket is installed for each canopy unit.

For anchor positions, refer to the attached "Anchor Drawing."

Installation Procedure

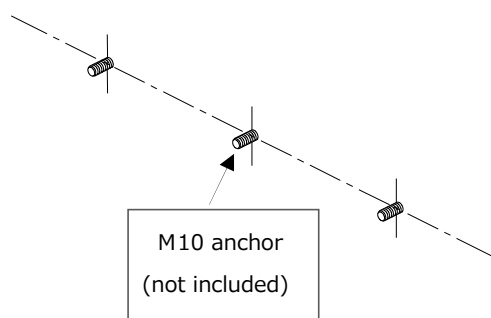

1

Mark the positions according to the anchor diagram and install M10 anchors (not included).

【Required items】

M10 anchor (not included)

RS-MS60、55、50,45 type

RS-MS40、35 type

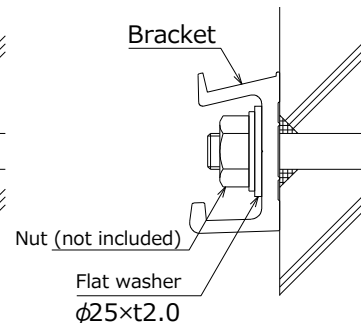
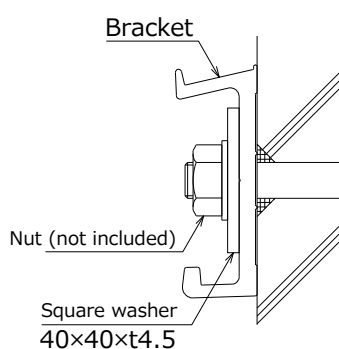

2

Install the bracket.

If the mounting surface is uneven, adjust by placing spacers (not included) behind the bracket.

*** Always use the supplied washer (see illustration above).**

*** If the bracket mounting surface is not properly aligned, the canopy body may not fit correctly. Be sure to level the bracket accurately.**

【Required items】

Bracket,
Washer (40×40×4.5 or φ25×2.0) ,
Nut (not included)

3

Attach the end cover to the canopy main body. Position the end cover so that the side with the waterproof gasket is in contact with the canopy body, then secure it using the supplied countersunk self-tapping screws.

[Required items]

End cover,
Countersunk self-tapping screw



Caution

Be sure to securely install the end cover.

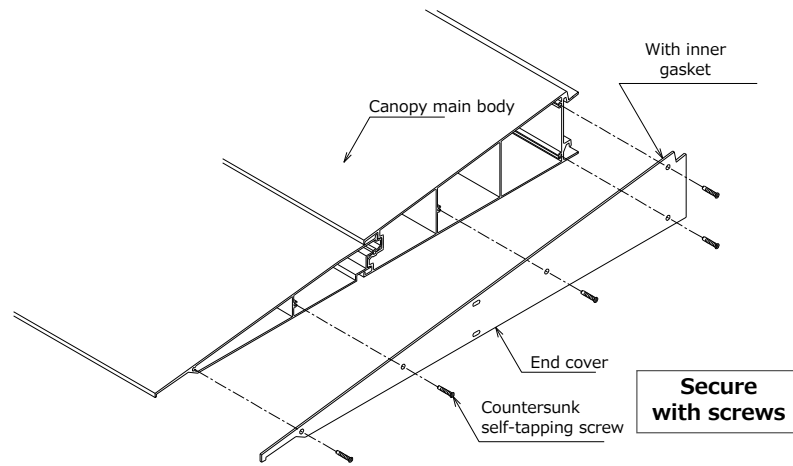

4 Attach the canopy to the brackets.

- ① Hook the canopy onto the brackets.
- ② Drill pilot holes, then secure with the supplied self-drilling screws.

Secure the canopy to the brackets.

- Fasten within 25 mm from the end of the bracket.
- If the bracket is a continuous member, fasten near each anchor point.
- The recommended pilot hole diameter is $\varnothing 4.2$ mm.

[Required items]

Canopy, Self-drilling screw



Caution

Always ensure that the canopy is properly hooked onto the brackets and securely fixed with self-drilling screws.

If the canopy becomes detached from the brackets, it may cause an accident.

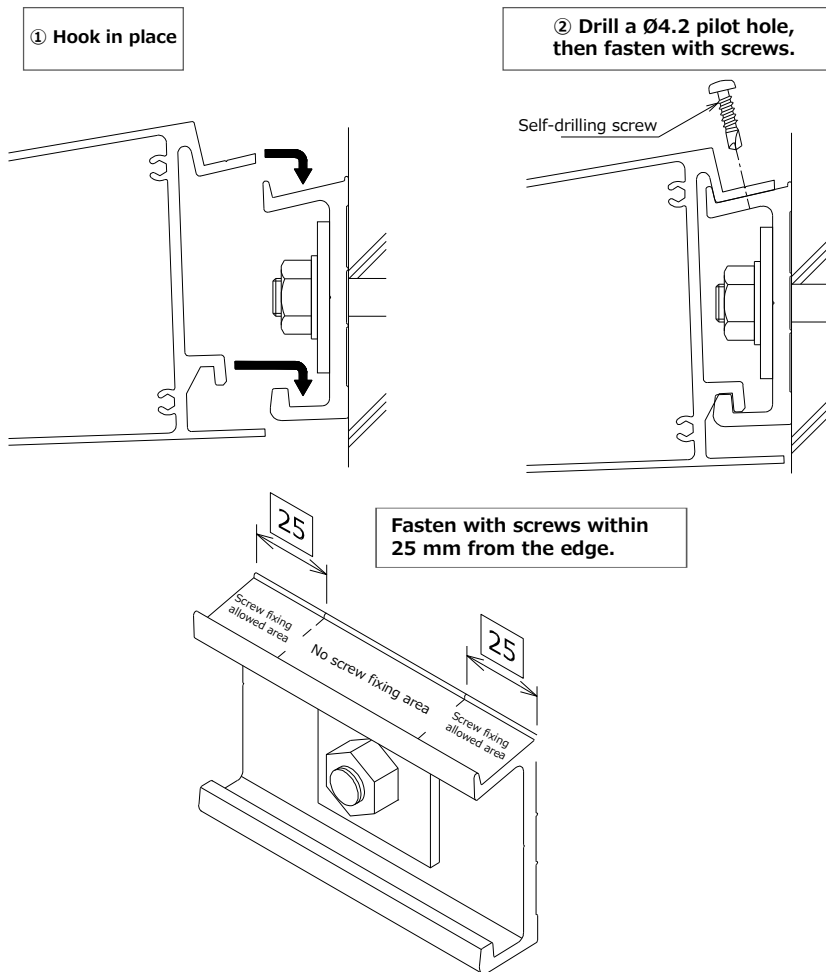

5

After installing the canopy, apply waterproof sealant (not included) to the upper section of the canopy and the edges of the end cover.

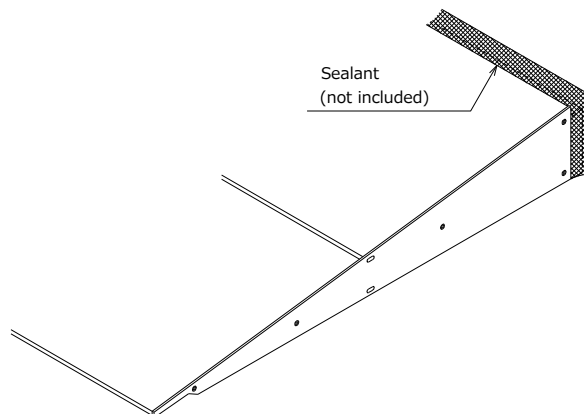

■ For consecutive installation of two or more canopy units / For corner installations

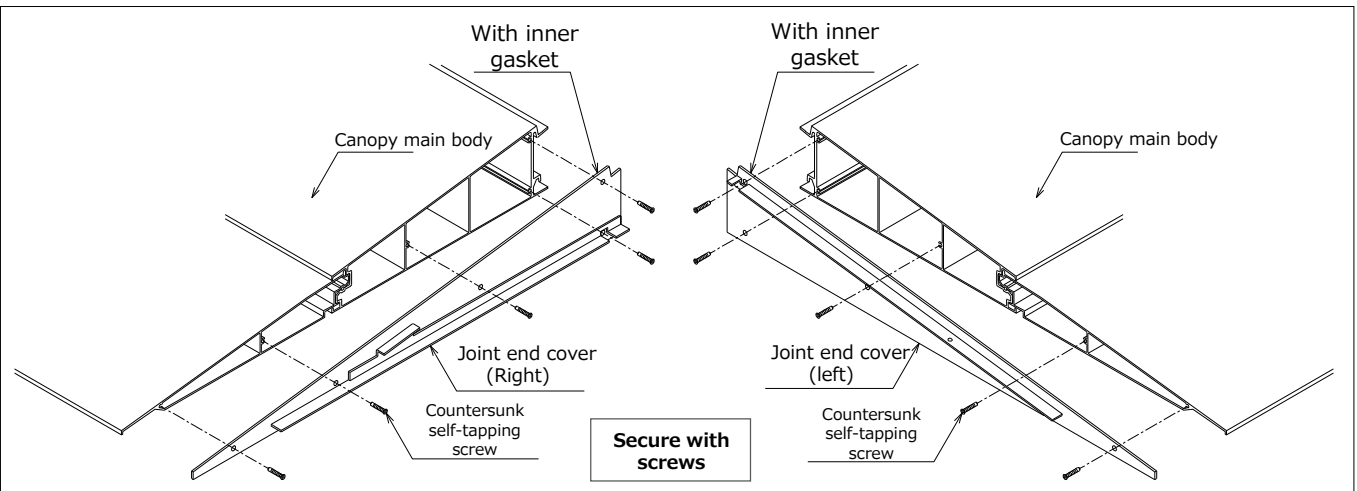

- 1** Attach the joint end cover to the canopy main body.
Note: The end caps for the corner sections are pre-installed.

Set the end cover so that the side with the waterproof sealing gasket is in contact with the canopy body, and secure it using the supplied countersunk self-tapping screws.

【Required items】

Joint end cover, Countersunk tapping screws



Caution

Please ensure that the end covers are securely installed.

2

Install the canopy on the brackets. Leave a 15 mm gap between the canopy units, then secure the seal receiver with the supplied flat-head self-drilling screws.

【Required items】

Countersunk self-drilling screw

Secure with screws

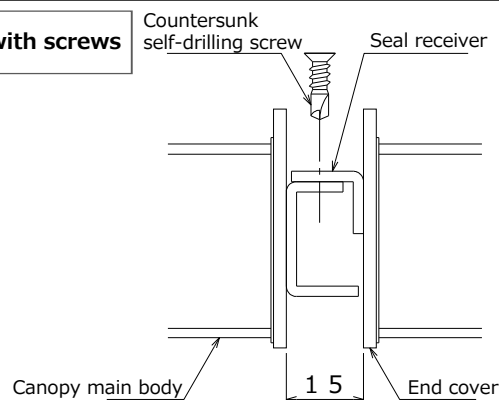

3

After installation, apply waterproof sealant(not included) to the joints, canopy top, and end cover edges.

