

# INSTALLATION MANUAL FOR SLIDEX HCS-120

For Door Weight 80kg~120kg.

Door Width 1000mm~1500mm (Effective Opening : less than 1350mm)

## Parts Details

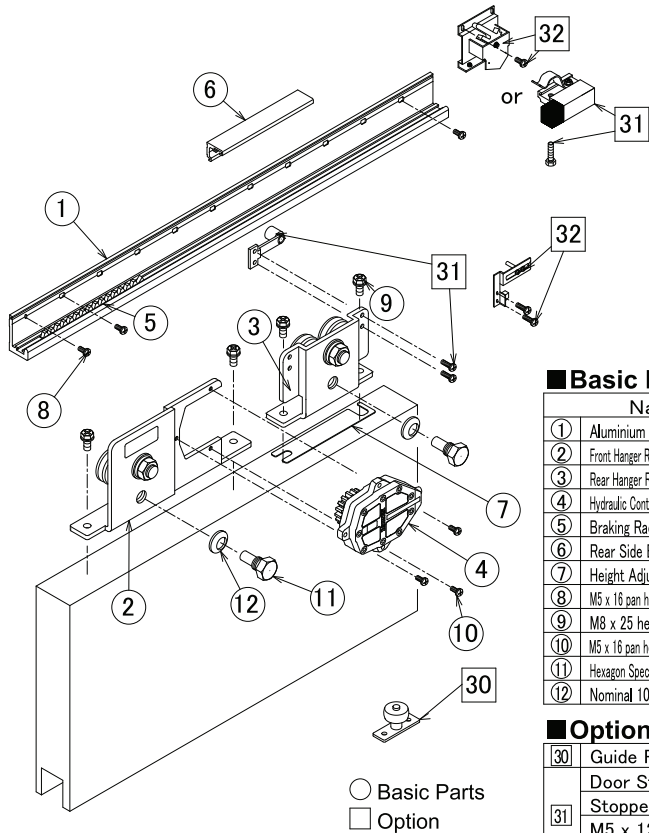

### Basic Parts

	Name	Material	Number
①	Aluminium Rail(L=2800)	Aluminium Materials	1
②	Front Hanger Roller (Sash Roller for Door Front)	Steel (Chromate) Resin	1
③	Rear Hanger Roller (Sash Roller for Door End)	Steel (Chromate) Resin	1
④	Hydraulic Control Unit (ADC12, Resin and others)	Alumi Die Cast Resin, etc.	1
⑤	Braking Rack	Resin (with G), Urethane	2
⑥	Rear Side Brake	Aluminium materials, Resin, Urethane	1
⑦	Height Adjustment Plate	Steel (processed steel plate)	6
⑧	M5 x 16 pan head screw (with unloosen proof)	Steel (Chromate)	12
⑨	M8 x 25 hexagon bolt	Steel (Chromate)	4
⑩	M5 x 16 pan head screw (with unloosen proof)	Steel (Chromate)	3
⑪	Hexagon Special Bolt for avoiding off-track	Steel (Chromate)	2
⑫	Nominal 10 countersunk spring washer	Stainless	2

### Option

③⑩	Guide Roller ※1	Stainless, Urethane (Retaining Ring is steel)	1
	Door Stop	Aluminium materials, Synthetic Rubber	1
③①	Stopper Roller	Steel (Chromate), Resin	1
	M5 x 12 pan head screw	Steel (Chromate)	2
	M6 x 20 hexagon bolt	Steel (Chromate)	1
③②	Delayed Timer ※2	Steel (Chromate), Resin, etc.	1
	Time adjusting plate	Steel (Chromate)	1
	M5 x 12 pan head screw	Steel (Chromate)	3

※1 Use tall type Guide Roller for effective opening more than 1,350mm

※2 Give us clear instructions for ③② delayed timer either HCS-DT120R for right hand opening or HCS-DT120L for left hand opening.

● ③① Door Stop and ③② Delayed Timer cannot be used together.

## Fit-in view

The view shows right hand sliding door. (Viewed from the inspection cover side.)

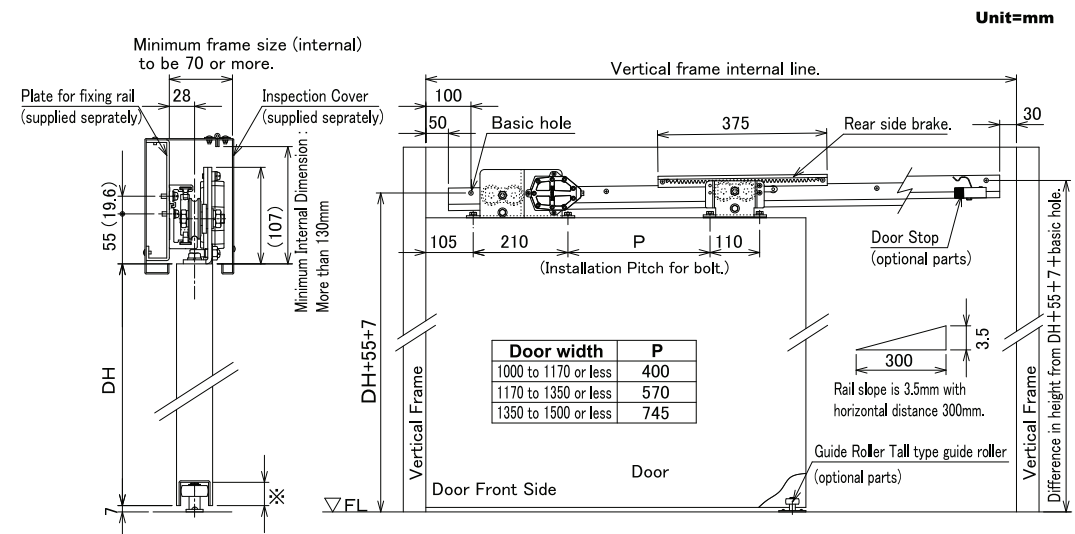

▪ Tall type guide roller, Door Stop are optional parts.

▪ Front Hanger Roller and Rear Hanger Roller to be fixed in perpendicularly.

▪ Guide Roller to be installed absolutely.

▪ ※ dimension to be more than 28mm when normal guide roller is used. And more than 36mm for tall type guide roller.

▪ Base plate & inspection cover are quoted separately.

# INSTALLATION MANUAL

This installation manual guides right hand sliding.  
Left hand sliding becomes symmetrical.

## 1 Machining of Aluminium Rail

When using optional parts such as door stop or delayed timer.

Insert into groove of the rail before cutting.

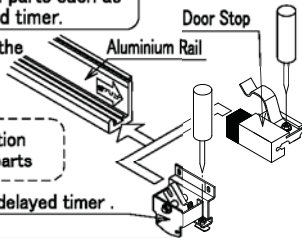

### !Caution!

Refer to the installation manual on optional parts

Cut the rail 80mm shorter from the internal line of the vertical frame (sash)(Cutting stamp side).

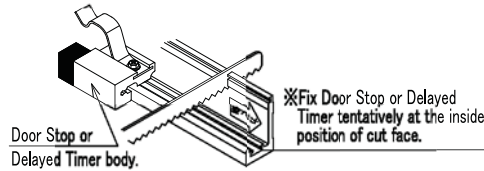

In case of bi-parting type or no vertical frame, door stop must be used(optional parts).

※Either of Door Stop for HCS or HCH is available.

① Take 38mm distance for HCS and 41mm for HCH from the front edge of aluminium rail then put a hole of 6.5mm  $\phi$  in the v ditch of rail. (at the bottom of rail).

Note: Slide the door stop a bit when drilling a hole.

② From door front side, set the door stop so that special nut can be inserted into rail ditch, then fasten tightly by M6 x 20 hexagon bolt from underneath and do the same by M4 hexagon bolt from top.

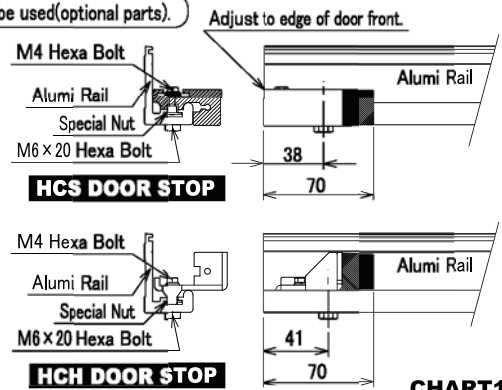

CHART1

### !Caution!

In case door stop is used for bi-parting, installation on opposite rail must be proceeded after both doors are hung.

## 3 Installation of Front Hanger Roller and Rear Hanger Roller

① Install the hanger rollers with basic position according to Table 1 in the condition of

W dimension	D	P
1000~1170	600	400
1170~1350	770	570
1350~1500	945	745

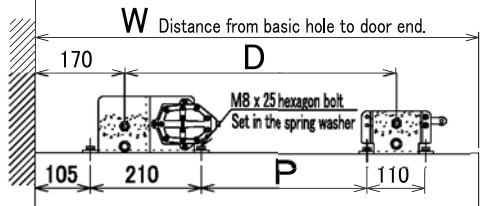

### !Caution!

• Install the hanger rollers perpendicularly. It creates any trouble if they are installed wrongly.  
• Locate and fix the hanger roller on the center line of door in alignment.

**BAD EXAMPLE**

**GOOD EXAMPLE**



② Insert the height adjustment plate according to the door width in Table 2.

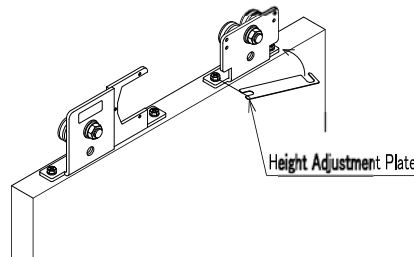

W dimension (mm)	Height adjustment plate
1000~1170	Unnecessary
1170~1350	2 pcs for Rear Hanger Roller
1350~1500	4 pcs for Rear Hanger Roller

※Please use balance plates for adjusting if door gets a leaning.

## 2 Installation of machined rails on the upper frame

① Set up of basic hole

Horizontal distance : 100mm from inside of vertical frame.

Distance A from Floor surface. : Door Height DH+55+7 Tap the hole of M5 pitch 0.8 at the position

② Set up the fixing holes on upper frame

Horizontal distance B from basic hole = number of oblong holes x 300mm (excluding basic round hole)

Height difference from basic hole C = B x 0.0116 (Taps are raised 3.5mm each with respect to a pitch of 300mm in horizontal distance.)

Number of oblong holes	4 pcs.	5 pcs.	6 pcs.	7 pcs.	8 pcs.	9 pcs.
<b>B</b> mm	1200	1500	1800	2100	2400	2700
<b>C</b> mm	13.9	17.4	20.9	24.4	27.9	31.4

Tap the hole with M5 pitch 0.8

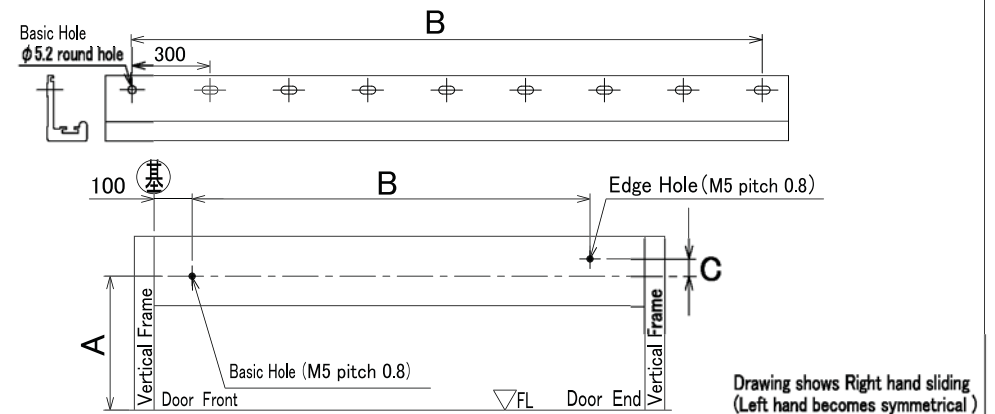

③ In case the edge hole is located more than 100mm from cut line of rail, please put 5.5  $\phi$  hole at the position within 50mm distance from cut line.

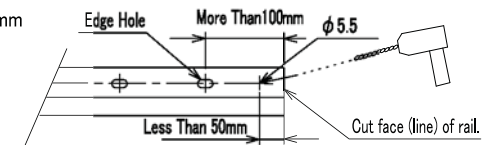

④ Fix the rail by M5 x 16 pan head screw tentatively on the extremely edge of right and left. Tap the hole of M5 x 0.8 along with oblong holes and fix the rail by M5 x 16 pan head screws.

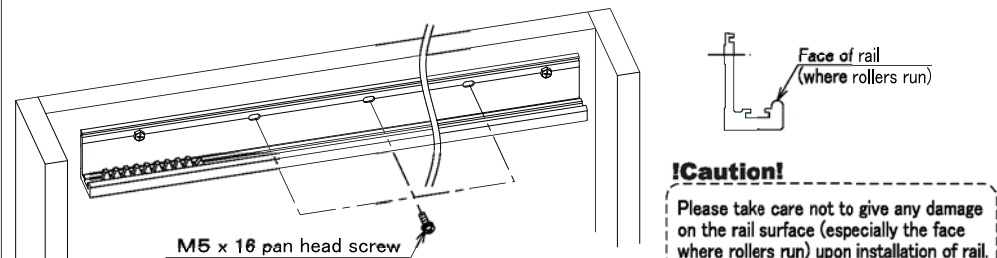

### !Caution!

Please take care not to give any damage on the rail surface (especially the face where rollers run) upon installation of rail.

### !Caution!

Don't push up or down the rail while you proceeding fixing job of rail.

## 4 Installation of the Guide Roller (Optional parts)

- Install the guide roller at the center of overlapped portion.
- Install the guide roller perpendicularly. (screws are not supplied)
- Use tall type guide roller in case door for effective entrance width becomes more than 1350mm.

Note: Guide Roller should be used absolutely

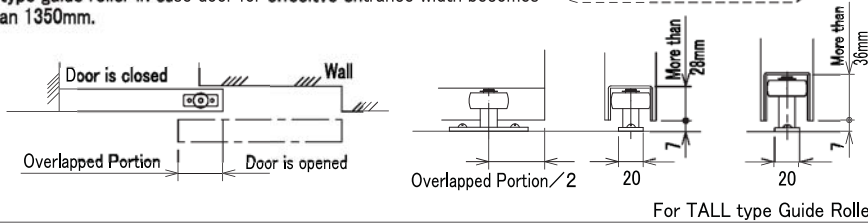

## 5 Door Hanging

- 1 Fit the guide roller with the bottom portion of the door.
- 2 Hang the Front Hanger Roller and Rear Hanger Roller on the rail. Check if the door can easily be opened and closed.

### !Caution!

- Take care so that the rail running surface is not scratched when hanging the door. Never start hanging door with Hydraulic Control Unit on Front Hanger Roller.
- At this stage, the brake does not work yet. Be careful about your fingers. Careless work will result in any case of your finger will be pinched.

- 3 Insert the countersunk spring washer into hexagon special bolt for both Front and Rear Hanger Rollers and tighten it.

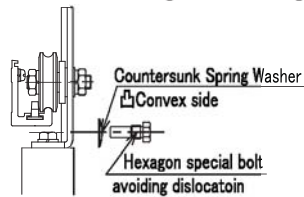

Note: Face spring washer part to head side of hexa bolt

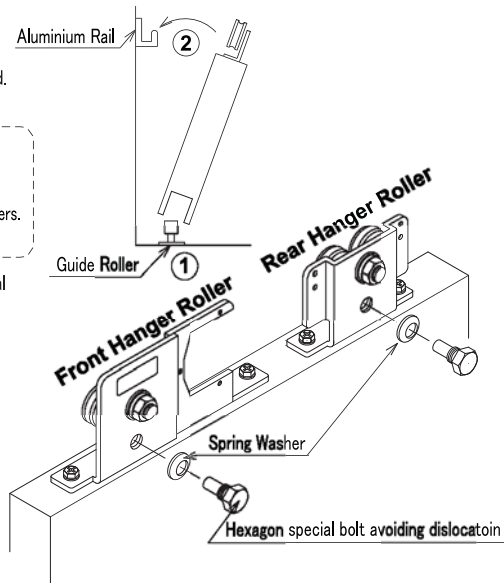

## 6 Installation of the Rear Side Brake

- 1 Allow the door to be fully opened or to be caught by door stop (or by delayed timer)

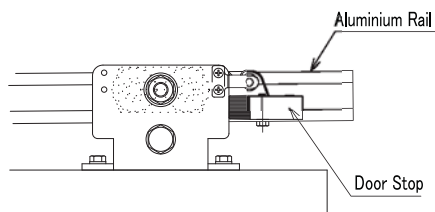

- 2 Insert the Rear Side Brake into the groove of the aluminium rail.

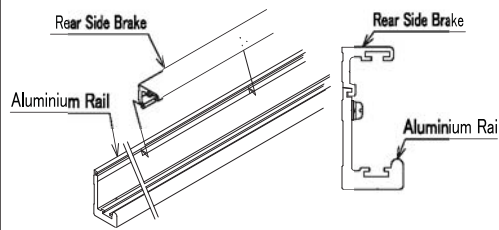

- 3 Adjust the edge line of Front Hanger Roller's tail with Rear Side Brake's end as per sketch then tap holes M5 pitch 0.8 along with the holes of rear side brake and fix it by pan head screws at 2 places.

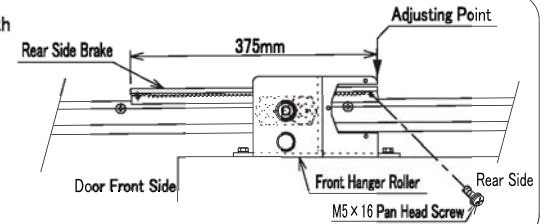

### Fixing of Door Stop for bi-parting installation. (Option)

- 1 Insert the special nut into groove portion of rail from the rail edge where door stop is not installed.
- 2 Close the door (having door stop) firstly then let it touch the door stop, then successively close opposite side door and adjust no clearance may have between two doors.
- 3 Slide the Door Stop after inserted and keep it the position with status of light touching by M4 hexagon bolt slightly.
- 4 At the cross point of arrow mark of Door Stop and V grooved of rail bottom, put hole-mark.
- 5 Loose the M4 hexagon bolt then slide it to slightly. Put a hole of 6.5mm  $\phi$  throughly on the marked point.
- 6 Put the door stop back to original position then fasten by M6 x 20 hexagon bolt strongly. Then fasten M4 hexagon bolt from upper side.

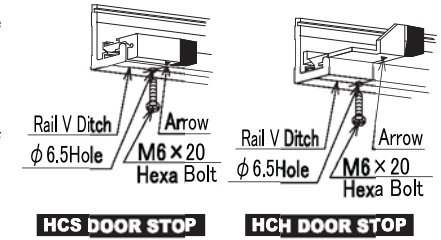

## 7 Installation of Hydraulic Control Unit

- Install the hydraulic control unit on the front hanger roller by using the pan head screw M5 x 163 pcs attached.
- Install it with the door more than half open.
- ※ Avoid the location of control rack (brake rack) and rear side brake.

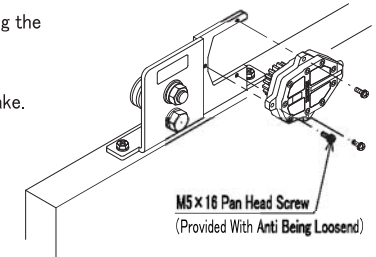

## 8 Adjustment of door closing speed

- Adjust the needle valve of the hydraulic control unit by using a flatblade screw driver.
- Adjust the needle valve so that the door closes with moderate closing speed from the position of fully opened condition.

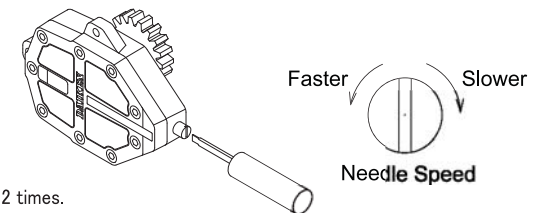

※ Do not turn the needle adjusting valve more than 2 times.

**Open and close the door 2 to 3 times and confirm if the hydraulic control functions well.**

**Completed**